



西贝虎 水陆两栖车
Amphibious All Terrain Vehicle



XBH 6×6-1 备件图册

XBH 6×6-1 Spare Parts Manual



前 言

Preface

- 本备件图册适用于 XBH 6×6-1 车型，供维修者及车主在更换零部件时参考。

This parts manual is suitable for the model of XBH 6X6-1 and can be used as a reference by mechanics and vehicle owners when replacing suitable parts.

- 在日常和定期维护中，更换老化或用坏的零部件可以从根本上提高车辆的使用寿命，为保证正确合理地安装零部件，在您维修更换前请查阅本备件图册。

Proper and regular service, including replacing old, worn or broken parts with the correct XBH parts, is essential to prolonging the life of the vehicle. Please refer to this parts manual for correct replacement.

- 本备件图册上的所有零部件基于印刷当时的生产制造规格，如果您所使用的 XBH 6×6-1 车型零部件规格与本手册不符请与本公司联系。

All information contained in this parts manual is based on the latest product specification available at time of printing. If your part's specifications differ from this manual, please contact our company.

- 如因本公司产品改进或换型所修改的项目恕不另行通知。

XBH reserves the right to alter specifications on the updated model at any time without prior notification.

- 在获得本公司书面授权之前，任何公司或个人不得生产制造 XBH 6×6-1 车型整车或零部件。

Reproduction of the XBH parts, in whole or in part, is prohibited without prior written permission from XBH.

- 如有疑问，请致电服务热线：4008-266-399(国内)。

Please contact us if you have any questions, tel:0086 0579 85419668 (International)



目 录

CONTENTS

1 发动机系统 Engine System.....	4
2 供给系统 Supply System	6
3 排气系统 Exhaust System	9
4 冷却系统 Cooling System	10
5 CVT	12
6 变速器 Transmission.....	13
7 传动系统 Drive Train.....	14
8 支承连接装置 Supporting and Coupling Device.....	18
9 车架 Chassis Frame	19
10 车轮 Wheel	20
11 转向系统 Steering System	21
12 制动系统 Braking System	23
13 电气设备 Electric Equipment	24
14 仪器仪表 Instrument	25
15 电线束 Wiring Harness	26
16 汽车灯具 Lamps.....	27
17 特种设备 Special Equipment.....	28
18 牵引骨架 Draw Frame.....	30
19 车身 Vehicle Body.....	31
20 护板 Fender Apron.....	33
21 车篷及侧围 Roof Head Lining and Side Wall.....	35
22 驾驶员座 Driver Seat	37
23 后座 Rear Passenger Seat	38
24 钣金件 Sheet-Metal Parts	39
25 电气原理图 Electric Circuit Diagram	40
26 EFR 原理图 EFR Circuit Diagram.....	43



1 发动机系统 Engine System

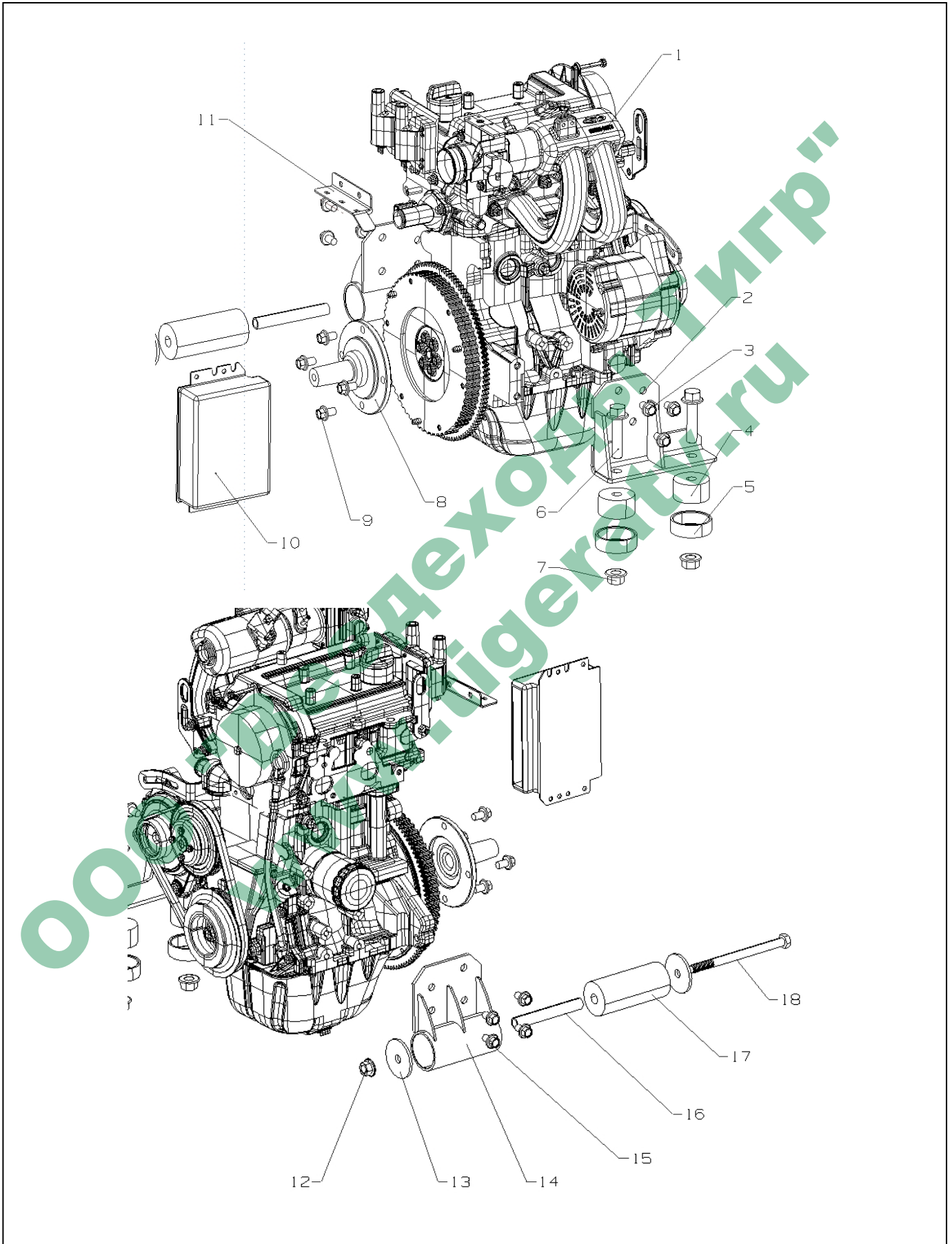



序号 NO. NO.	零件号 Part Number.	零件名称 Description	台量 Qty.
1	1000010-401	发动机总成 Engine Assembly	1
2	1001010-401	发动机后悬置 Engine Rear Mounting	1
3	Q1841020	六角法兰面螺栓 Hexagon Bolt with Flange	3
4	1001012-201	发动机机脚垫 Engine Pad	2
5	1001013-001	机脚垫护套 Engine Pad Sheath	2
6	Q1841460	六角法兰面螺栓 Hexagon Bolt with Flange	2
7	Q32014	六角法兰面螺母 Hexagon Nut with Flange	2
8	1005020-201	发动机输出轴总成 Engine Output Shaft Assembly	1
9	Q1841016	六角法兰面螺栓 Hexagon Bolt with Flange	4
10	1026011-401	发动机 ECU Engine ECU	1
11	4001012-401	发动机线束固定支架 Engine Wiring Harness Clamp	1
12	QX98712	六角凸缘防松螺母 Hexagon Nut with Flange	1
13	1001016-201	后机脚垫垫片 Rear Engine Foot Pad Shim	1
14	1001020-401	发动机前悬置 Engine Front Mounting	1
15	Q1841020	六角法兰面螺栓 Hexagon Bolt with Flange	4
16	1001017-201	后机脚垫套管 Engine Rear Foot Pad Sleeve	1
17	1001014-201-01	发动机后机脚垫 Engine Rear Foot Pad	1
18	Q150B12160	六角头螺栓 Hexagon-headed Bolt	1



2 供给系统 Supply System

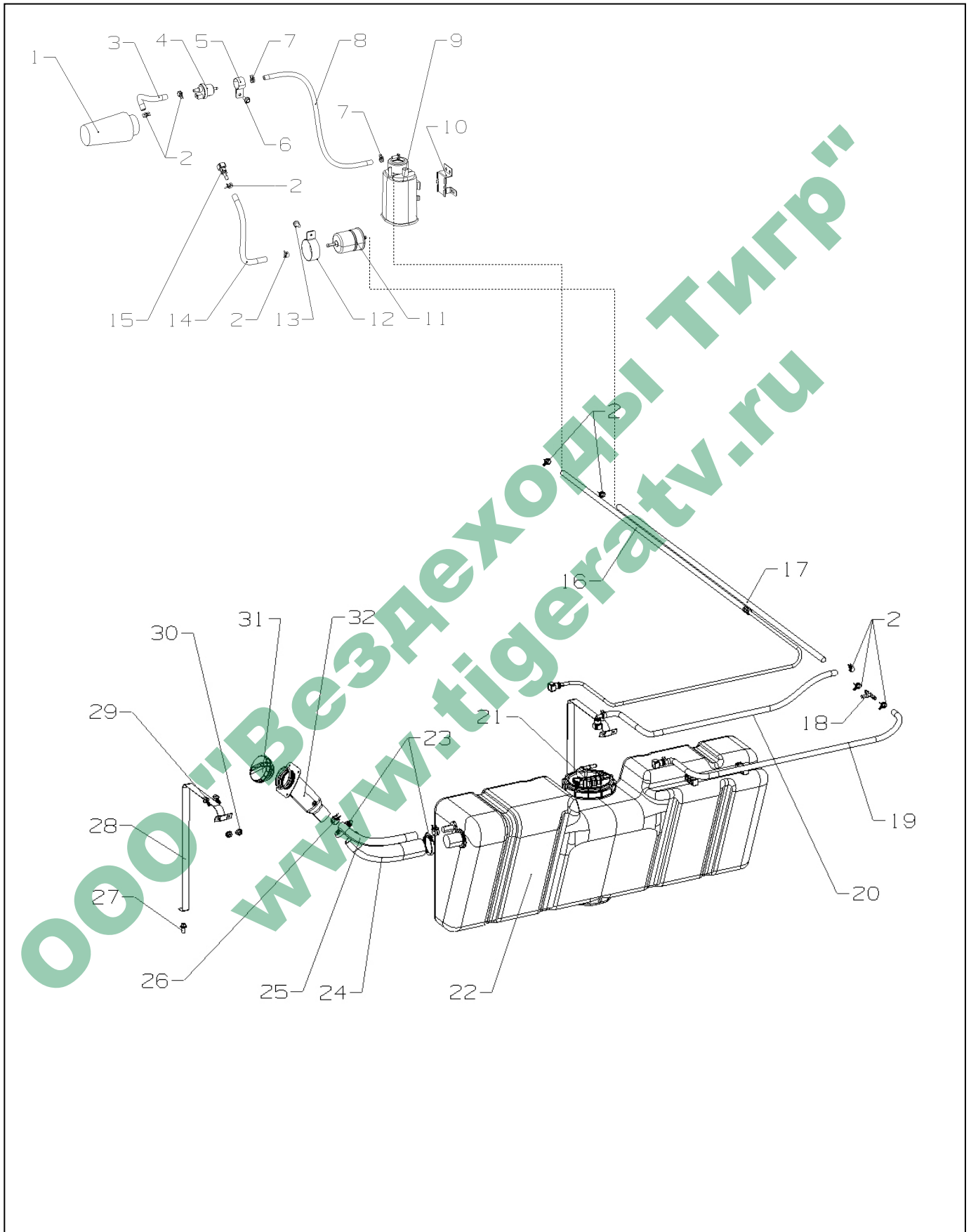



序号 NO.	零件号 Part Number.	零件名称 Description	台量 Qty.
1	1109010-401	空气滤清器 Air Filter	1
2	Q673B13	钢带型弹性环箍 Elastic Steel Hoop	12
3	1130016-201	碳罐阀真空管 Carbon Pot Valve Vacuum Tube	1
4	1130012-201	碳罐阀 Carbon Pot Valve	1
5	1130014-201	碳罐阀抱箍 Carbon Pot Valve Hoop	1
6	Q1840616	六角法兰面螺栓 Hexagon Bolt with Flange	1
7	Q673B11	钢带型弹性环箍 Elastic Steel Hoop	2
8	1130015-401	碳罐阀软管 Carbon Pot Valve Hose	1
9	1130011-201	碳罐 Carbon Pot	1
10	1130013-201	碳罐支架 Carbon Pot Bracket	1
11	1117011-001	燃油细滤器 Fuel Filter	1
12	1117012-201	燃油细滤器抱箍 Fuel Fine Filter Hoop	1
13	Q1840616	六角法兰面螺栓 Hexagon Bolt with Flange	1
14	1104022-201	后进油管 Oil Inlet Pipe-Rear	1
15	1104023-201	燃油分配器快速接头 Fuel Distributor Fast Connector	1
16	1104040-201	气管 Air Tube	1
17	1104021-401	进油连接管 Oil Inlet Tube	1
18	1104036-201	三通接头 three way tie-in	1
19	1104030-201	回油管 Oil Return Pipe	1
20	1104020-201	出油管 Oil Outlet Pipe	1
21	1106010-201	电喷燃油泵总成 EFI Pump Assembly	1
22	1101010-001	燃油箱 Fuel Tank	1
23	Q67650	B 型蜗杆传动式软管抱箍 B TYPE WORM DRIVE TUBE HOOP	2
24	1104012-201	加油口软管 Oil Filler Hose	1
25	1104013-201	加油口排气软管 Oil Filler Exhaust Hose	1
26	Q673B19	钢带型弹性环箍 Elastic Steel Hoop	2
27	Q1840620	六角法兰面螺栓 Hexagon Bolt with Flange	2
28	1101020-201	燃油箱固定带 Fuel Tank Bind Stick	2
29	Q1840820	六角法兰面螺栓 Hexagon Bolt with Flange	4



30	Q32008	六角法兰面螺母 Hexagon Nut with Flange	4
31	1103011-201	油箱盖 Fuel Tank Cap	1
32	1104011-201	加油口总成 Re-fuelling Valve Assembly	1
			1

ООО "Вездеходы Тигр"
www.tigeratv.ru



3 排气系统 Exhaust System

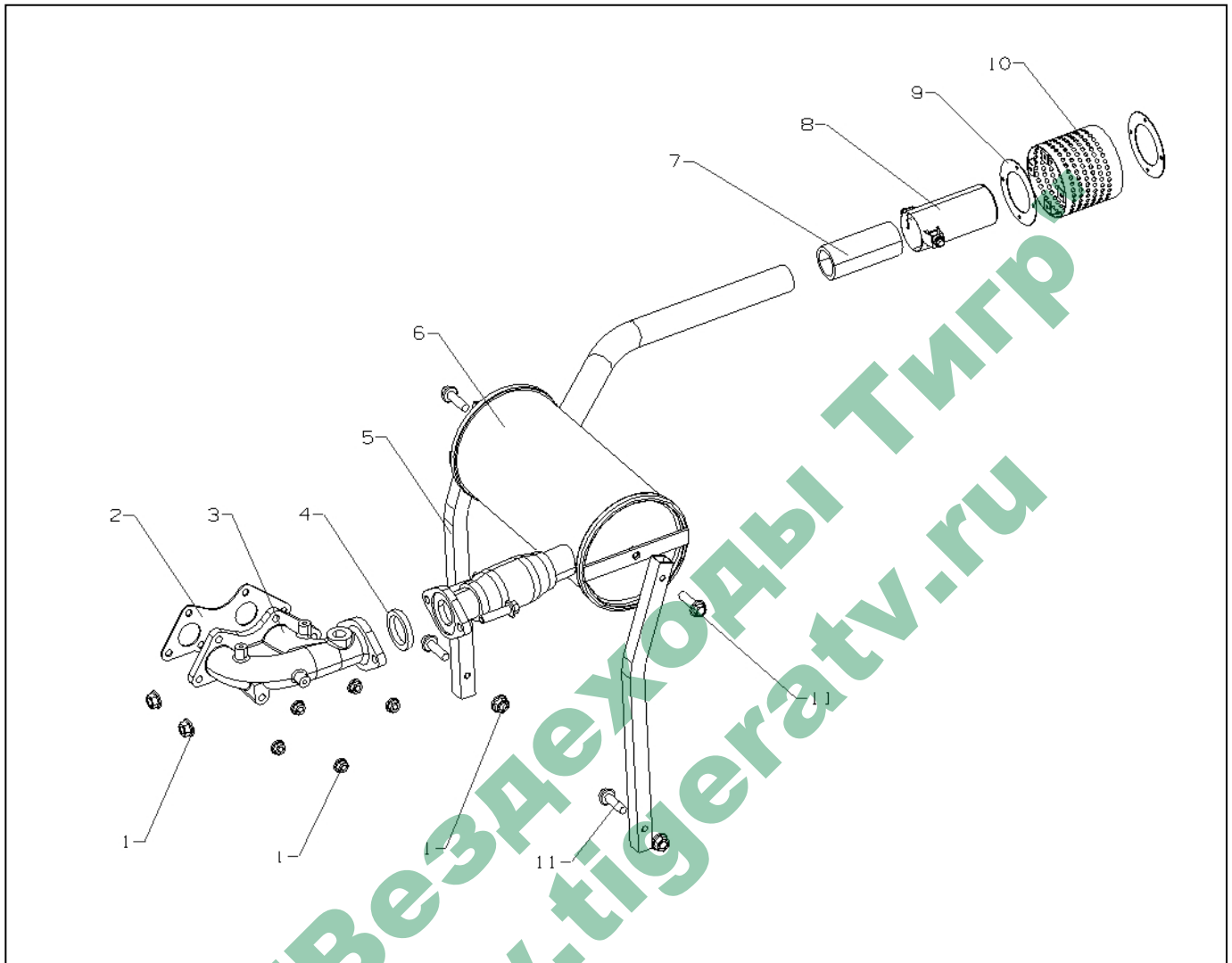

序号 NO.	零件号 Part Number.	零件名称 Description	台量 Qty.
1	Q32008	六角法兰面螺母 Hexagon Nut with Flange	9
2	1203014-401	排气歧管衬垫 Exhaust Manifold Pad	1
3	1203011-401	排气歧管 Exhaust Manifold	1
4	1203016-001	接口垫圈 Interface Gasket	1
5	1201012-401	消声器支撑管 Muffler Bracket	2
6	1201010-401	消声器总成 Muffler	1
7	1209013-001	隔热管 Insulated Pipe	1
8	1209011-001	尾管外件 Tail Pipe External Part	1
9	1209012-001	尾件固定片 Tailpiece Stator	2
10	1209020-201	尾管防烫罩 Tail Pipe Insulated Cover	1
11	Q1840835	六角法兰面螺栓 Hexagon Bolt with Flange	4



4 冷却系统 Cooling System

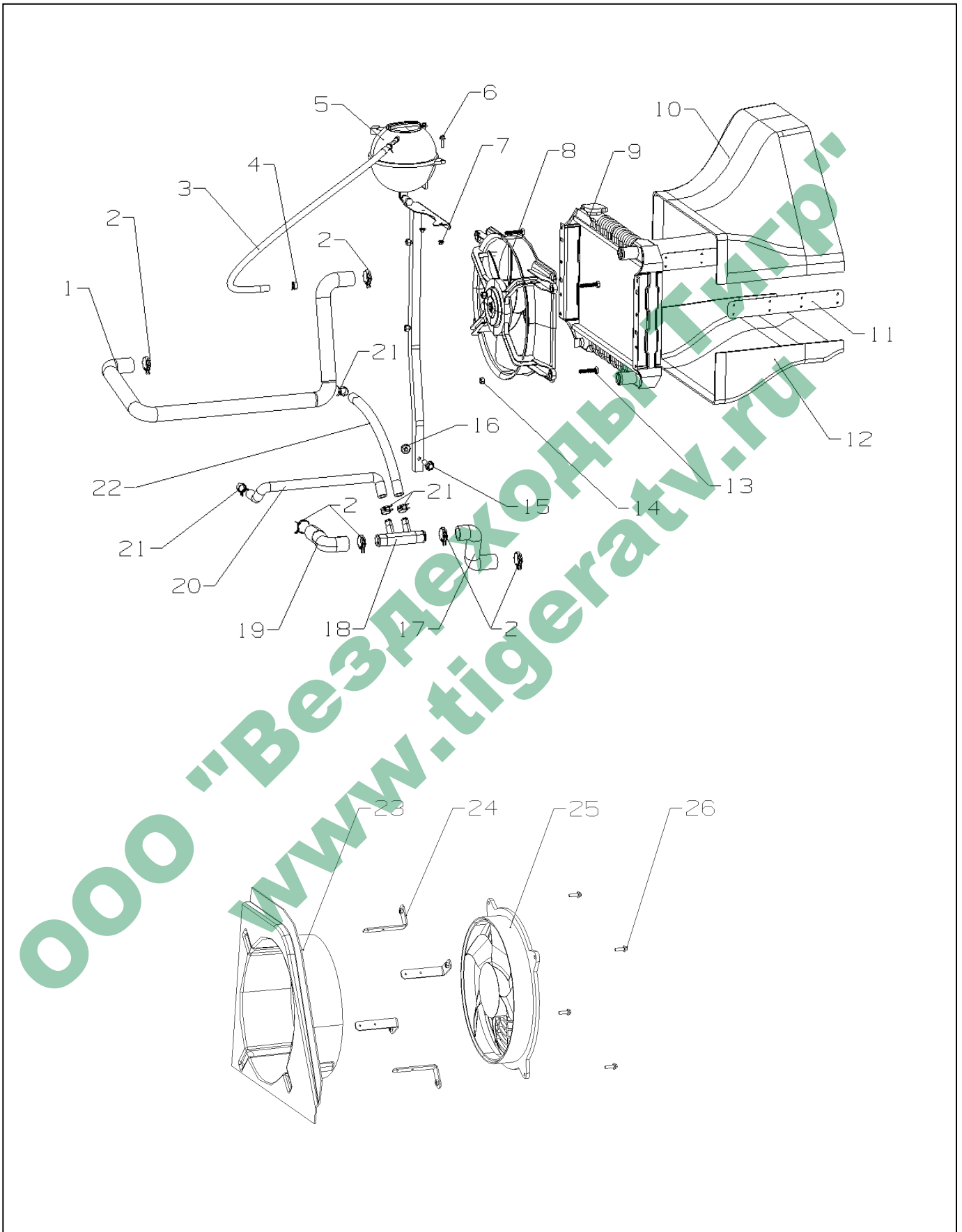



序号 NO.	零件号 Part Number.	零件名称 Description	台量 Qty.
1	1303013-401	发动机出水管 Engine Outlet Pipe	1
2	Q673B30	钢带型弹性环箍 Elastic Steel Hoop	6
3	1311013-401	膨胀水壶连接水管 Expansion Kettle Connecting Water Pipe	1
4	Q673B13	钢带型弹性环箍 Elastic Steel Hoop	2
5	1311011-201	膨胀水壶 Expansion Kettle	1
6	Q1840620	六角法兰面螺栓 Hexagon Bolt with Flange	2
7	Q32006	六角法兰面螺母 Hexagon Nut with Flange	2
8	1308010-001	出风道电子扇 Duct Electronic Fan	1
9	1301010-401	散热器总成 Radiator	1
10	1310011-401	进风道上件 Intake shaft Up Part	1
11	1310014-401	进风道连接件 Intake shaft Tie-in Part	2
12	1310012-401	进风道下件 Intake shaft Down Part	1
13	Q1840835	六角法兰面螺栓 Hexagon Bolt with Flange	4
14	Q32008	六角法兰面螺母 Hexagon Nut with Flange	4
15	Q1840835	六角法兰面螺栓 Hexagon Bolt with Flange	1
16	Q32008	六角法兰面螺母 Hexagon Nut with Flange	1
17	1303012-401	散热器出水管 Radiator Outlet Pipe	1
18	1303040-001	四通阀 Four-way Valve	1
19	1303011-401	发动机进水管 Engine Feed Line	1
20	1311021-401	小循环水管 Minor Cycle Conduit	1
21	Q673B19	钢带型弹性环箍 Elastic Steel Hoop	4
22	1311015-401	膨胀水壶出水管 Expansion Kettle Discharging Tube	1
23	1310040-401	出风道 Duct	1
24	1310041-401	风扇支架 Fan Bracket	4
25	1308020-401	排风扇 Fan	1
26	Q1840620	六角法兰面螺栓 Hexagon Bolt with Flange	4



5 CVT

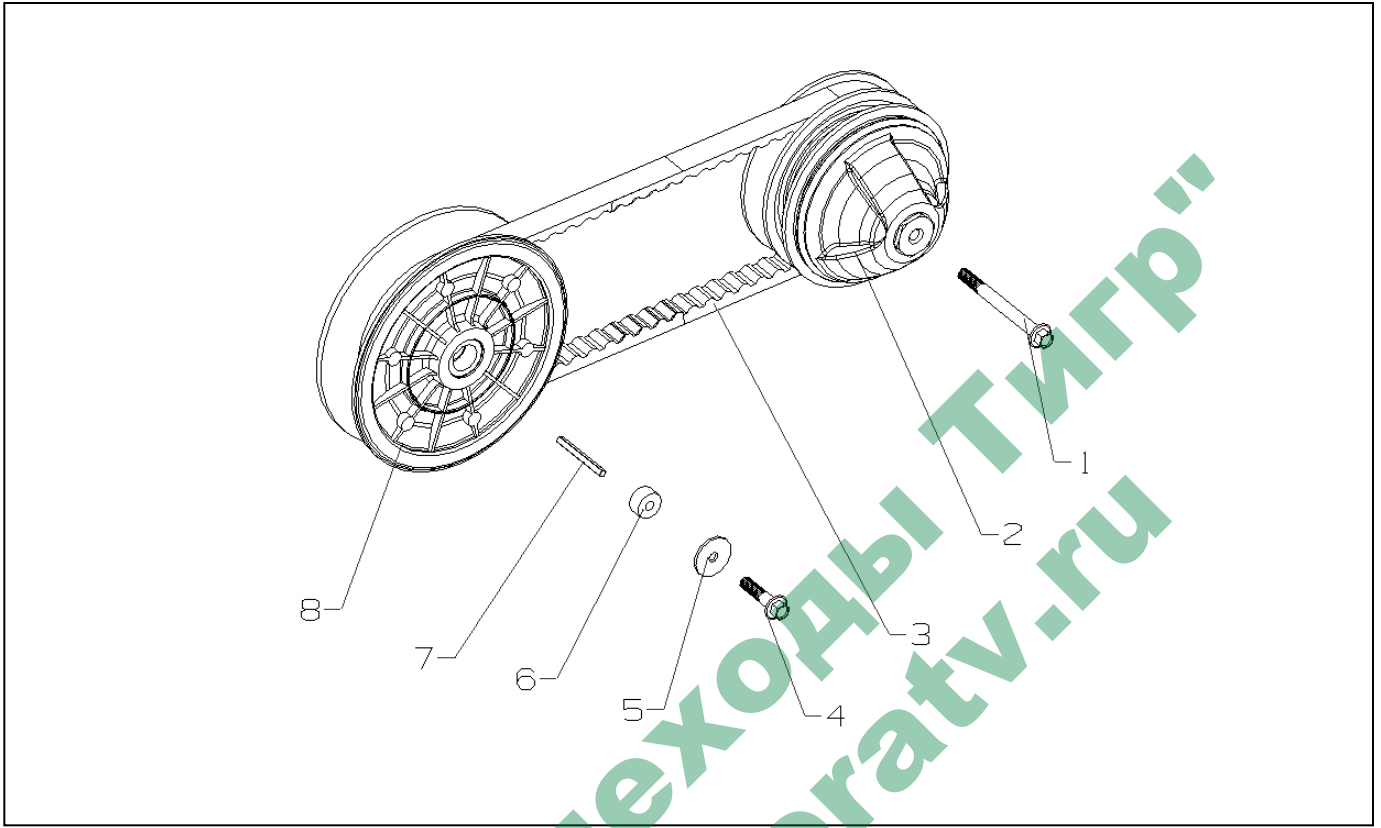

序号 NO.	零件号 Part Number.	零件名称 Description	台量 Qty.
1	Q18412125	六角法兰面螺栓 Hexagon Bolt with Flange M12x1.5	1
2	1601100-201	CVT 主动轮总成 CVT Drive Wheel Assembly	1
3	1601011-401	CVT 传动带 CVT Driving Belt	1
4	Q1841040	六角法兰面螺栓 Hexagon Bolt with Flange	1
5	2202117-201	大垫圈 Big Washers	1
6	1704017-201	端面垫块 End Pad	1
7	Q5510670	普通平键 General Flat Key	1
8	1601200-201	CVT 从动轮总成 CVT Driven Wheel Assembly	1



6 变速器 Transmission

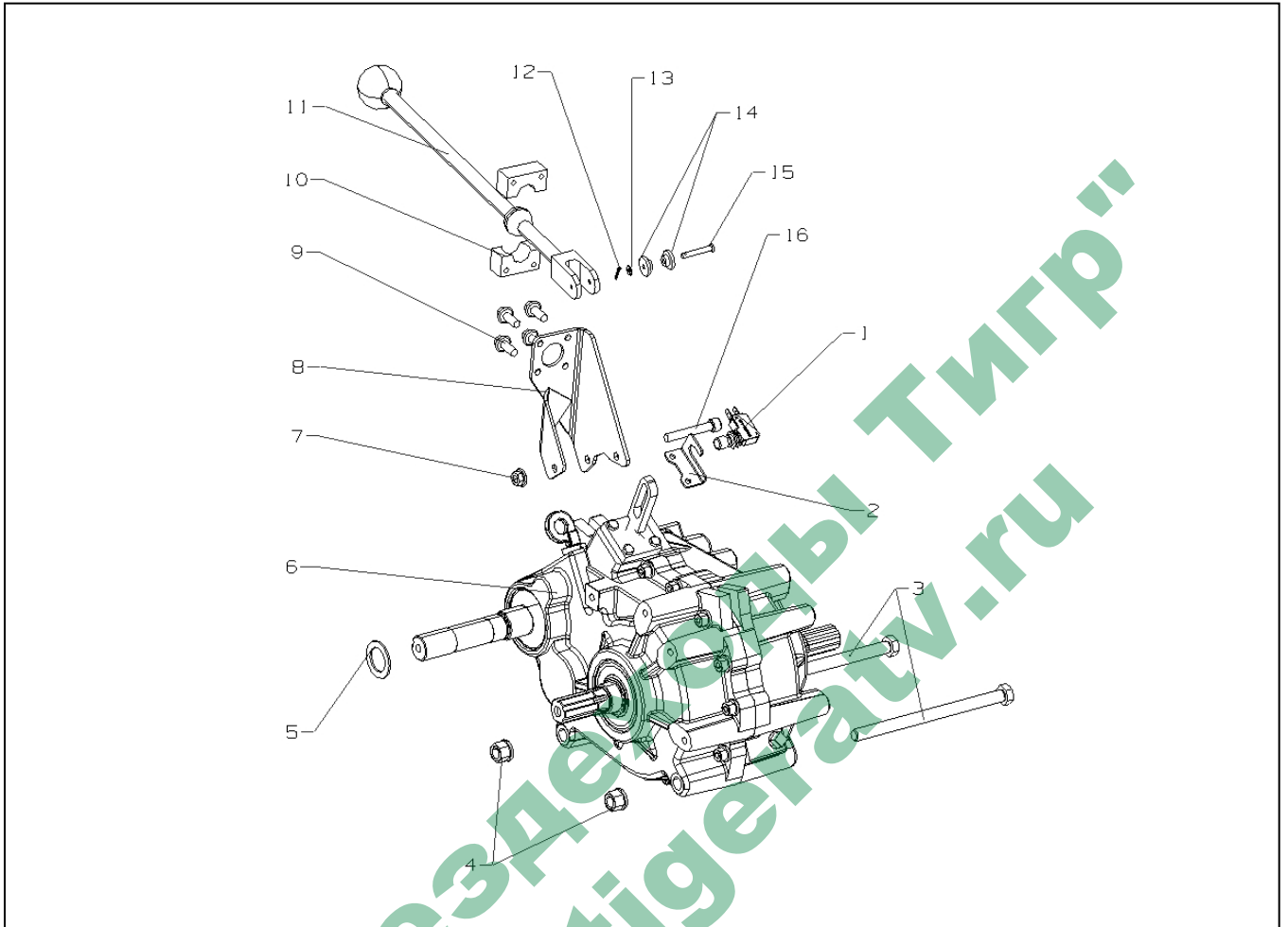

序号 NO.	零件号 Part Number.	零件名称 Description	台量 Qty.
1	3721018-201	微动开关 Reverse gear Switch	1
2	1706021-201	倒档报警开关支架 Reverse gear Switch Bracket	1
3	Q150B12180	六角头螺栓 Hexagon-headed Bolt	2
4	QX98712	六角凸缘防松螺母 Hexagon Nut with Flange	2
5	1704016-201-01	轴肩垫片 Middle Washers	1
6	1701010-401	变速器主体 Transmission Body	1
7	Q32008	六角法兰面螺母 Hexagon Nut with Flange	1
8	1702020-401	换档机构支撑架总成 Shifting Bracket Assembly	1
9	Q1840620	六角法兰面螺栓 Hexagon Bolt with Flange	4
10	1702013-401	操纵杆支撑座 Shifting Control Support Seats	1
11	1702015-401	操纵杆总成 Shifting Control Handle	1
12	Q5002018	开口销 Split Pin	1
13	40105	平垫圈 Flat Washer	1
14	1702023-401	尼龙轴套 Nylon Sleeve	2
15	Q5100532	销轴 Pin	1



7 传动系统 Drive Train

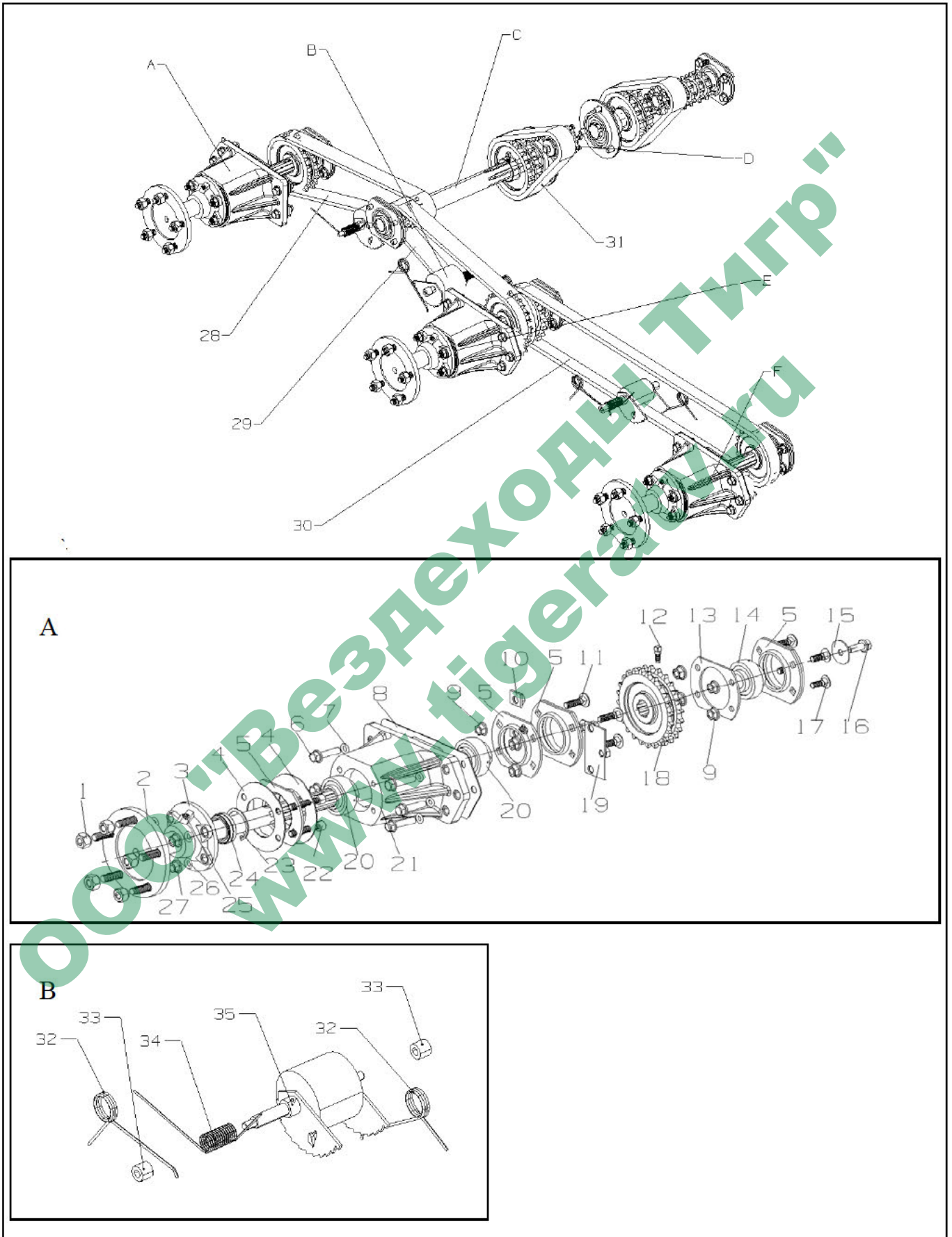

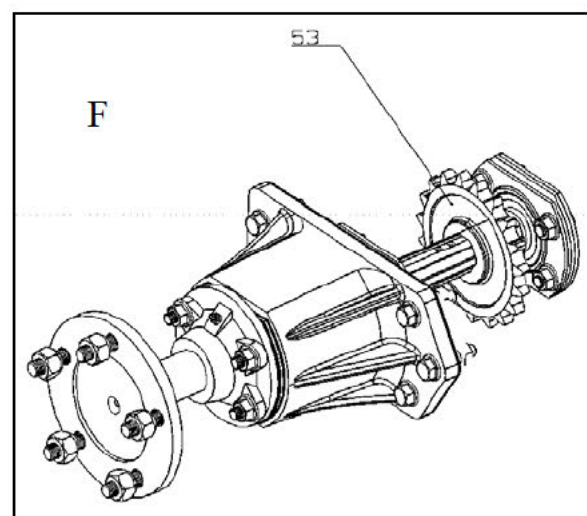
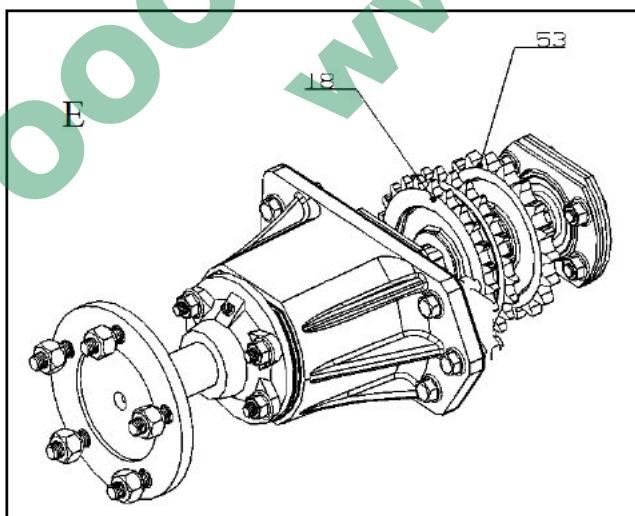
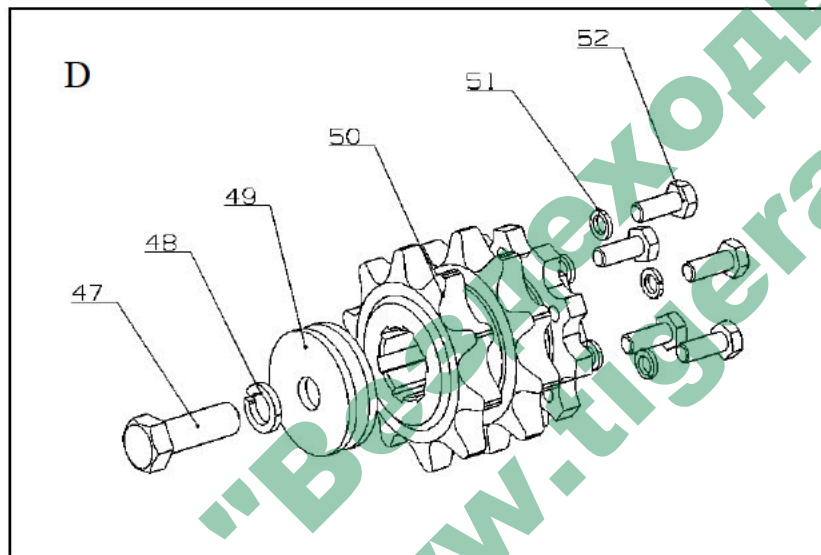
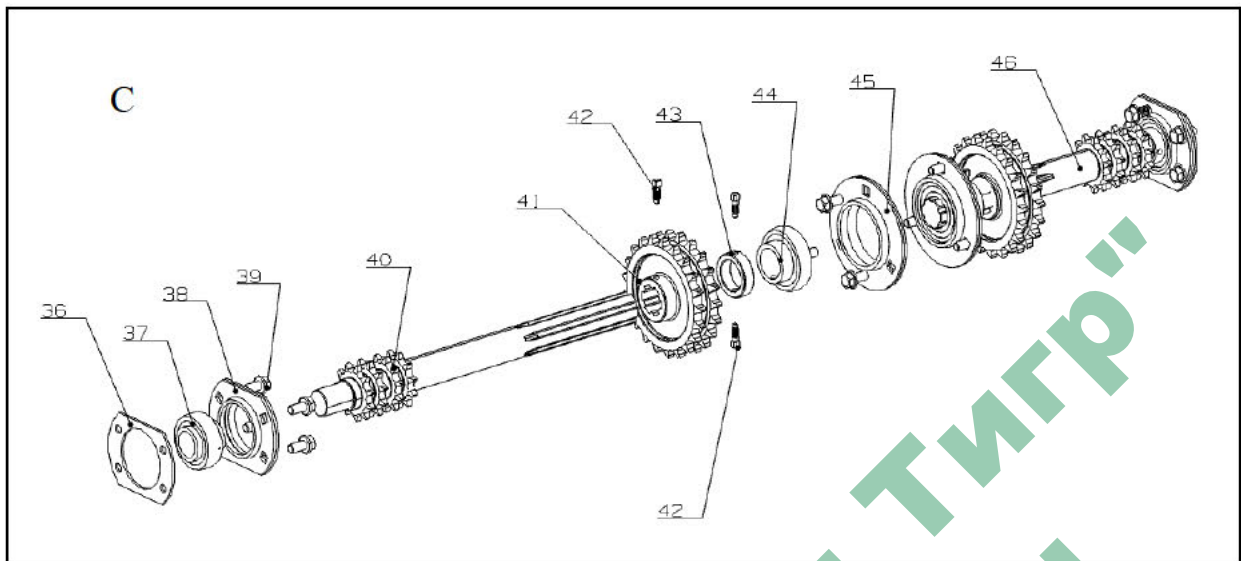



序号 NO.	零件号 Part Number.	零件名称 Description	台量 Qty.
1	3101014-001	轮胎螺母 Type Nut	30
2	2202020-201-05	轮轴总成 Wheel Shaft Assembly	6
3	2202122-001-01	油封座 Oil Seal	6
4	2202123-201	油封座垫 Oil Seal Seat Cushion	6
5	2202118-201	冲压座 Stamping Base	18
6	Q1841040	六角法兰面螺栓 Hexagon Bolt with Flange	30
7	QX96509355	O 型橡胶密封圈 9x3.55 O Type Rubber Seal Ring 9x3.55	30
8	2202121-201	支撑座垫 Basket-Bearing Extension	6
9	Q32010	六角法兰面螺母 Hexagon Nut with Flange	48
10	2202135-201	支撑座小垫板 Small Basket-Bearing Extension	12
11	QX9751035	小半圆头低方颈螺栓 M10x35 Small Cup Head Short Square Neck Bolts M10x35	24
12	Q2860816	方头长圆柱端紧定螺钉 Square Set Screws With Long Dog Point	8
13	2202139-201-01	纵板大垫片 Longitudinal board gaskets	6
14	QX930UC305	轴承 UC305 Bearing UC305	6
15	2202117-201	大垫圈 Big Washers	6
16	Q1841025	六角法兰面螺栓 Hexagon Bolt with Flange	6
17	QX9751025	小半圆头低方颈螺栓 M10x25 Small Cup Head Short Square Neck Bolts M10x35	24
18	2202114-201-01	双排链轮 Double Row Sprocket	4
19	2202125-201	支撑座大垫板 Support Seats Big Subplate	6
20	QX930UC206	轴承 UC206 Bearing UC206	12
21	2202119-001	支撑座 Support Seats	6
22	Q218B1050	内六角圆柱头螺钉 Socket Head Cap Screws	24
23	Q43048	孔用弹性挡圈 Circlips For Holes	6
24	QX960FB334806	油封 33x48x6 Oil Seal 33x48x6	12
25	Q700B06	直通式压注油杯 M6 Straight Hydraulic Grease Nipples M6	6
26	QX96509355	O 型橡胶密封圈 9x3.55 O Type Rubber Seal Ring 9x3.55	24
27	Q32010	六角法兰面螺母 Hexagon Nut with Flange	24
28	QX94010A268	双排链条 10A-2x68 Double Row Chain 10A-2x68	2



序号 NO.	零件号 Part Number.	零件名称 Description	台量 Qty.
29	QX94010A262	双排链条 10A-2x62 Double Row Chain 10A-2x62	2
30	QX94012A196	单排链条 12A-1x96 Single Row Chain 12A-1x96	2
31	QX94012A234	双排链条 12A-2-34 Double Row Chain 12A-2-34	2
32	2201025-001	扭簧 2.7 Torsion Spring 2.7	12
33	2201028-201	升降轴轴套 Axle Sleeve	6
34	2201024-201	扭簧 2.0 Torsion Spring 2.0	6
35	2201010-201-04	张紧装置总成 Tensioning Assembly	6
36	2202139-201-01	纵板大垫片 Longitudinal Board Gaskets	2
37	QX930UC206	轴承 UC206 Bearing UC206	2
38	2202118-201	冲压座 Stamping Base	2
39	Q1841020	六角法兰面螺栓 Hexagon Bolt with Flange	8
40	2202111-401	左侧传动轴 Left Transmission Shaft	1
41	2202115-201	主动双链轮 Driving Double Chain Wheel	2
42	Q2860816	方头长圆柱端紧定螺钉 Square Set Screws With Long Dog Point	6
43	2202129-201	传动轴定位套 Transmission Shaft Fix Loop	2
44	QX930SB207	轴承 SB207 Bearing SB207	2
45	QX935PF207	轴承座 PF207 Bearing Pedestal PF207	2
46	2202112-401	右侧传动轴 Right Transmission Shaft	1
47	Q151B1030	六角头螺栓 Hexagon-headed Bolt-细牙 M10x1	2
48	Q40310	弹簧垫圈 Spring Washer	2
49	2202117-201	大垫圈 Big Washers	4
50	2202116-001	变速箱输出链轮 Gearbox Output Sprocket	2
51	Q40306	弹簧垫圈 Spring Washer	10
52	Q150B0616	六角头螺栓 Hexagon-headed Bolt	10
53	2202113-001	单排链轮 Single Row Chain Wheel	4



8 支承连接装置 Supporting and Coupling Device

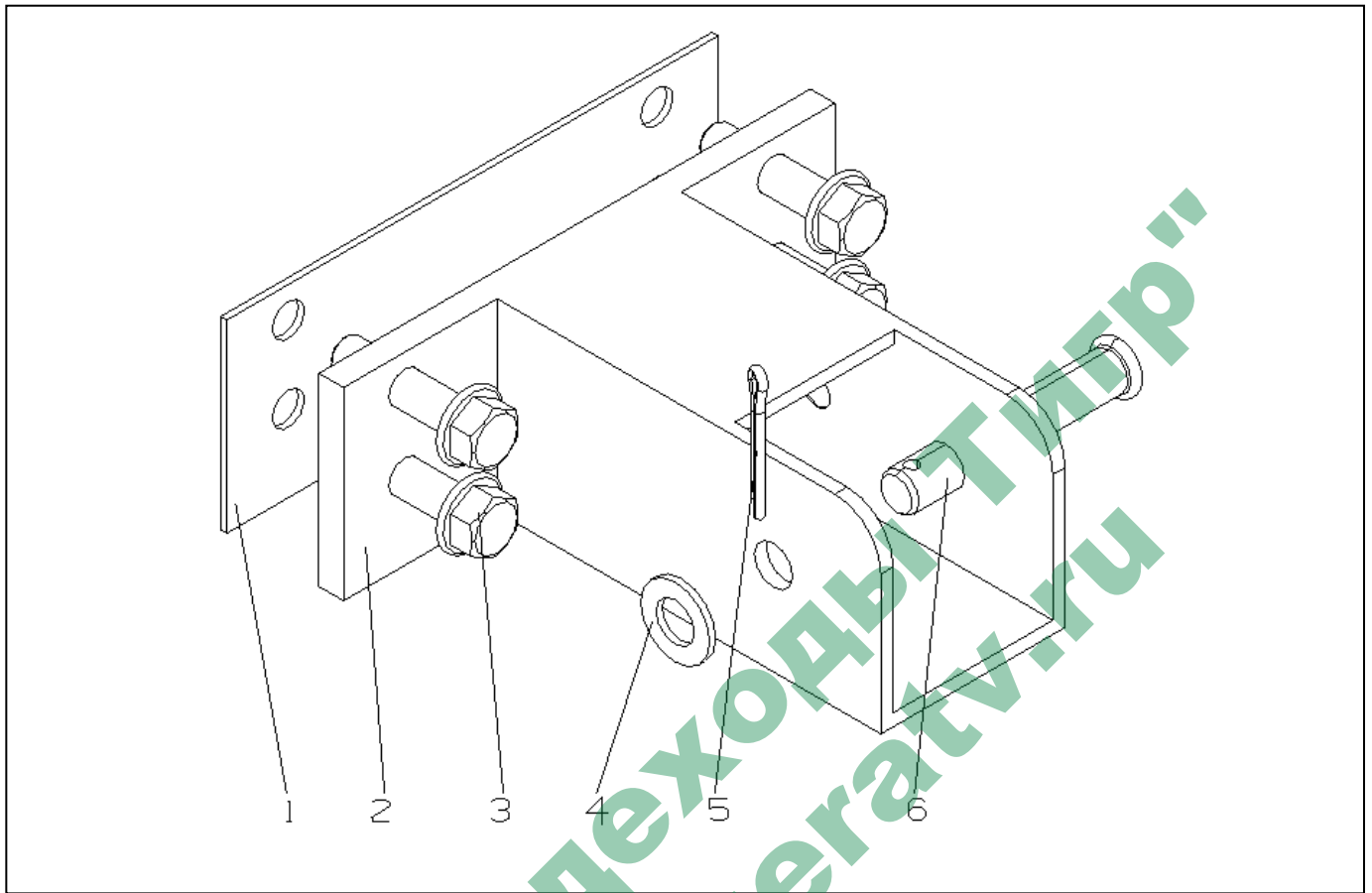

序号 NO.	零件号 Part Number.	零件名称 Description	台量 Qty.
1	2702023-201	后牵引垫 Rear Drag Pad	1
2	2702030-201	可翻转后牵引 Reversible Rear Drag	1
3	Q1841040	六角法兰面螺栓 Hexagon Bolt with Flange	4
4	Q40112	平垫圈 Flat washer	1
5	Q5003236	开口销 Split Pin	1
6	Q5101270	销轴 Clevis Pin with Head	1



9 车架 Chassis Frame

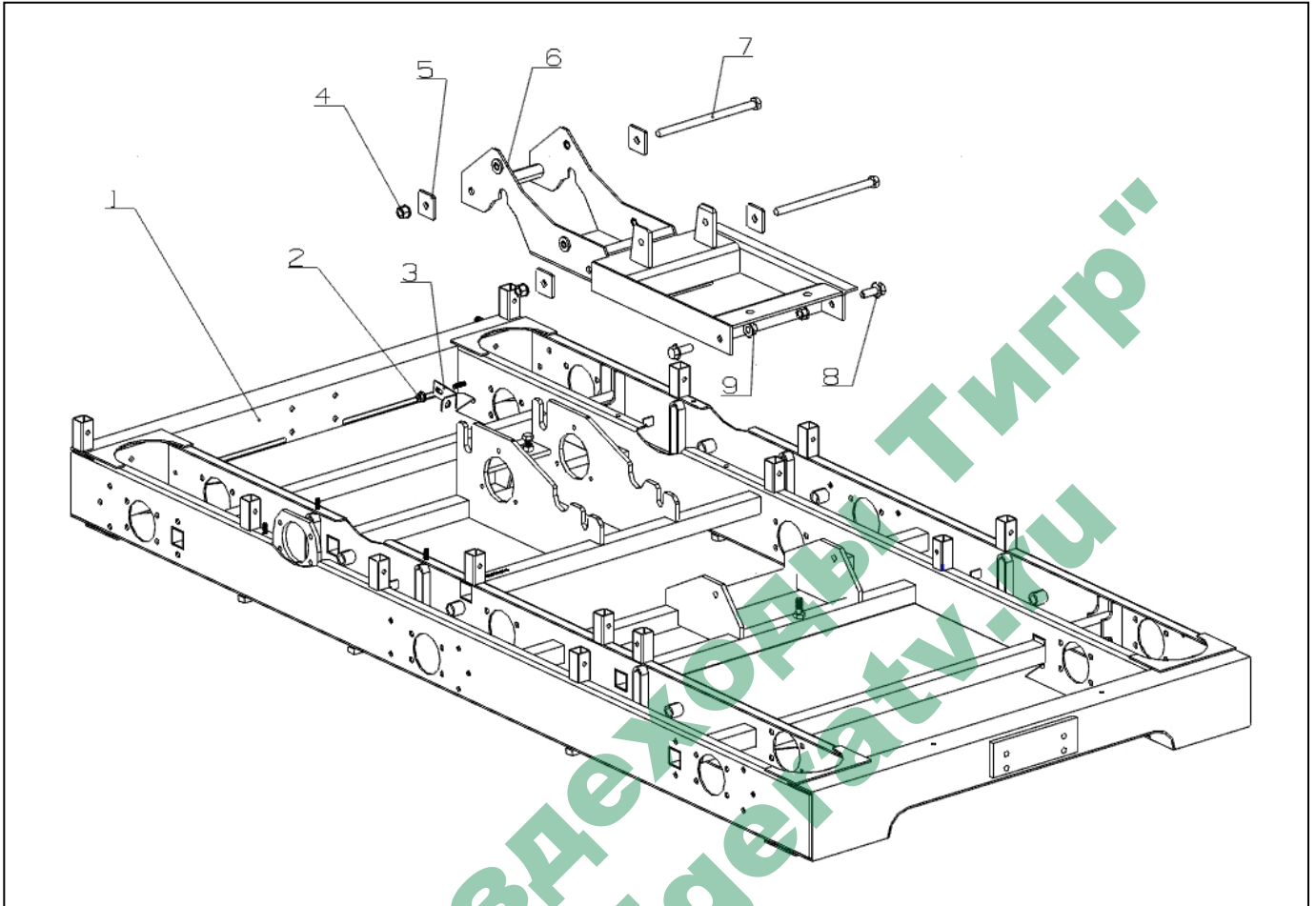

序号 NO.	零件号 Part Number.	零件名称 Description	台量 Qty.
1	2801100-401	车架 Frame	1
2	Q32008	六角法兰面螺母 Hexagon Nut with Flange	1
3	2801102-201-01	测速器传感器支架 The Speed Sensor Stents	1
4	QX98712	六角凸缘防松螺母 Hexagon Nut with Flange	2
5	2801331-201	方垫板 Square Subplate	4
6	2801310-401	机架总成 Rack	1
7	Q150B12200	六角头螺栓 Hexagon-headed Bolt	2
8	Q1841230	六角法兰面螺栓 Hexagon Bolt with Flange	2
9	Q32012	六角法兰面螺母 Hexagon Nut with Flange	2



10 车轮 Wheel



序号 NO.	零件号 Part Number.	零件名称 Description	台量 Qty.
1	3101014-001	轮胎螺母 Tyre Nut	30
2	3101013-001	气门嘴 Inflating Valve	6
3	3101011-001	轮毂 Wheel Hub	6
4	3101016-001	右轮胎 Right Wheel	3
5	3101012-001	左轮胎 Left Wheel	3



11 转向系统 Steering System

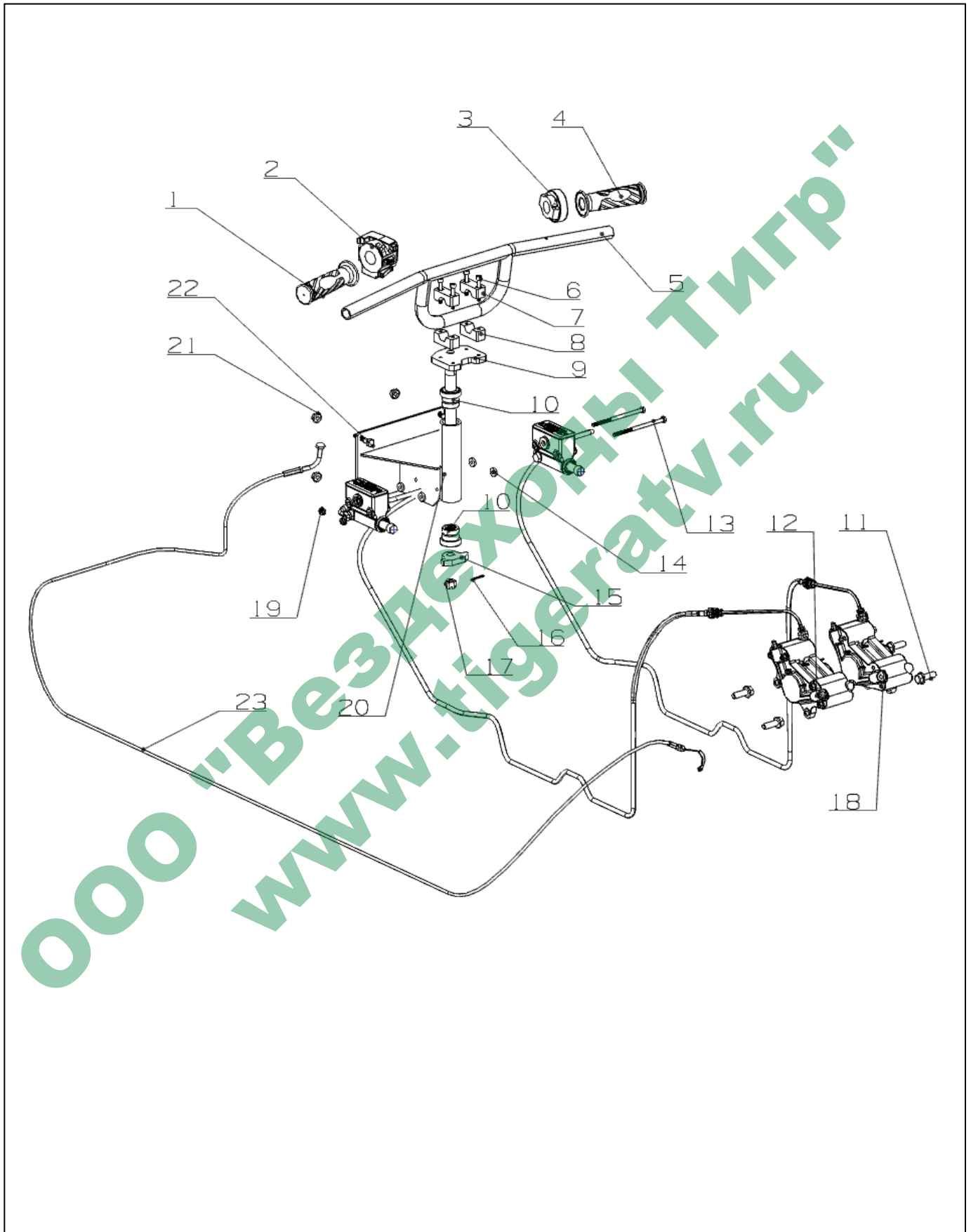



序号 NO.	零件号 Part Number.	零件名称 Description	台量 Qty.
1	3400115-001	左握把 Left Grip	1
2	3400031-001	多功能开关 Multi-functional Switch	1
3	3400021-001	油门座 Throttle Base	1
4	3400116-001	右握把 Right Grip	1
5	3400102-201-01	转向把 Steering Handle	1
6	Q218B0640	内六角圆柱头螺钉 Hexagon Socket Head Cap Screws	4
7	3400103-201	把手紧固件上 Handle Fastener, Upper	2
8	3400104-201	把手紧固件下 Handle Fastener, Lower	2
9	3400105-201	把手转动轴总成 Handle Axis Assembly	1
10	QX930NK20Z	组合轴承 NK20Z Combination Bearing NK20Z	2
11	Q1841030	六角法兰面螺栓 Hexagon Bolt with Flange	4
12	3401020-401	右侧转向制动器总成 The Right to Brake Assembly	1
13	Q150B06110	六角头螺栓 Hexagon-headed Bolt	2
14	3401014-201	转向制动总泵垫块 Steering Brake Master Cylinder Pad	4
15	3400119-201	转向顶块 Steering Convex Piece	1
16	Q5002532	开口销 Split Pin	1
17	Q381B10	1型六角开槽螺母-细牙 1 Type Hexagon Bolt with hole	1
18	3401010-401	左侧转向制动器总成 The Left to Brake Assembly	1
19	Q32006	六角法兰面螺母 Hexagon Nut with Flange	2
20	3400120-401	把手固定件总成 Handle Fixed Assembly	1
21	Q32008	六角法兰面螺母 Hexagon Nut with Flange	4
22	Q1840840	六角法兰面螺栓 Hexagon Bolt with Flange	4
23	3400108-401	油门线 Cable Asm ,Throttle	1



12 制动系统 Braking System

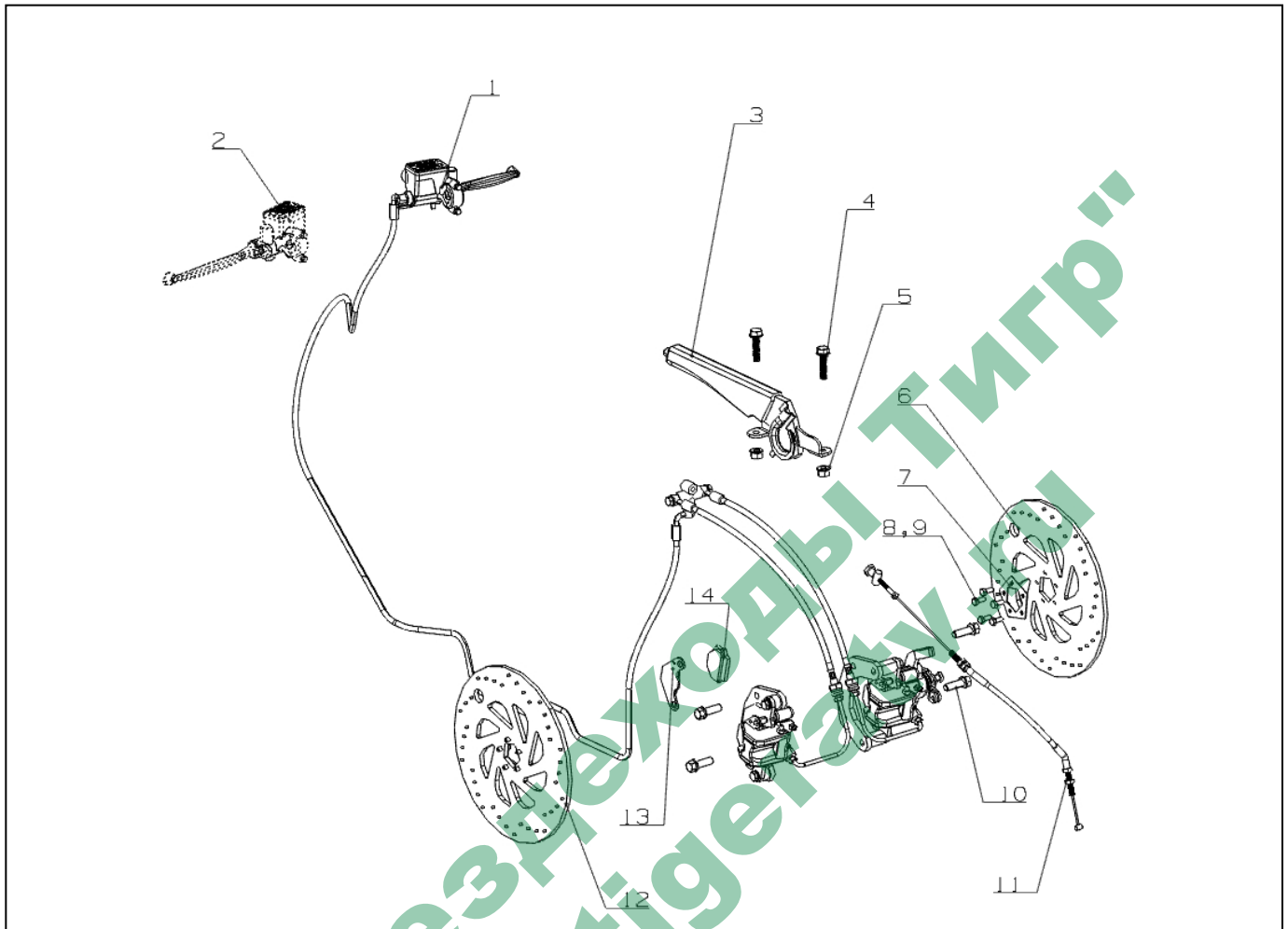

序号 NO.	零件号 Part Number.	零件名称 Description	台量 Qty.
1	3505000-401	刹车总成 Braking Assembly	1
2	3505100-401	左置刹车总成 Left Braking Assembly	1
3	3508011-201	驻车手柄 Parking Brake Handle	1
4	Q1840835	六角法兰面螺栓 Hexagon Bolt with Flange	2
5	Q32008	六角法兰面螺母 Hexagon Nut with Flange	2
6	3501012-201	右侧制动盘 Right Braking	1
7	3501013-001	锁紧垫片 Lock Washer	2
8	Q150B0616	六角头螺栓 Hexagon-headed Bolt	10
9	Q40306	弹簧垫圈 Spring Washer	10
10	Q1841030	六角法兰面螺栓 Hexagon Bolt with Flange	4
11	3508015-401	驻车拉线总成 Parking Stay Wire Assembly	1
12	3501011-201	左侧制动盘 Left Braking	1
13	3505012-201-01	刹车制动外片 Outside Braking	2
14	3505011-201	刹车制动内片 Inside Braking	2



13 电气设备 Electric Equipment

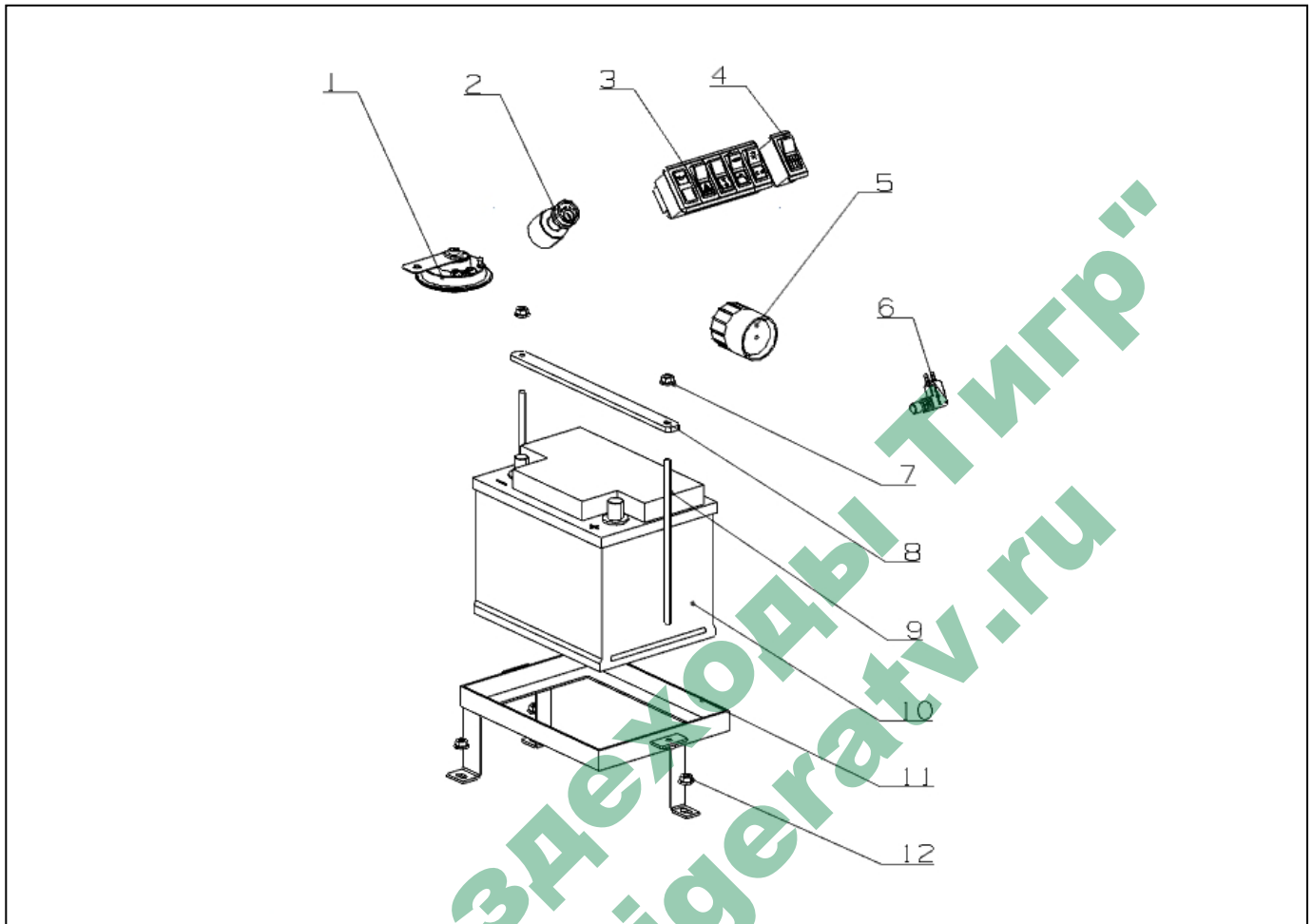

序号 NO.	零件号 Part Number.	零件名称 Description	台量 Qty.
1	3721011-001	电喇叭 Horn	1
2	3704011-001	点火开关 Ignition Switch	1
3	3749050-401	翘板组合开关 Rocker Switch Combo	1
4	3749061-201	暖风开关 Warn wind Switch	1
5	3721016-201	倒车蜂鸣器 Back Buzzer	1
6	3721018-201	微动开关 Reverse gear Switch	1
7	Q32008	六角法兰面螺母 Hexagon Nut with Flange	2
8	3703013-201	蓄电池固定板 Battery Fixture	1
9	3703012-001	电瓶丝杆 Battery Screw	2
10	3703011-001	蓄电池 Battery	1
11	3703020-401	蓄电池固定支架总成 Battery Bracket	1
12	Q32008	六角法兰面螺母 Hexagon Nut with Flange	3



14 仪器仪表 Instrument

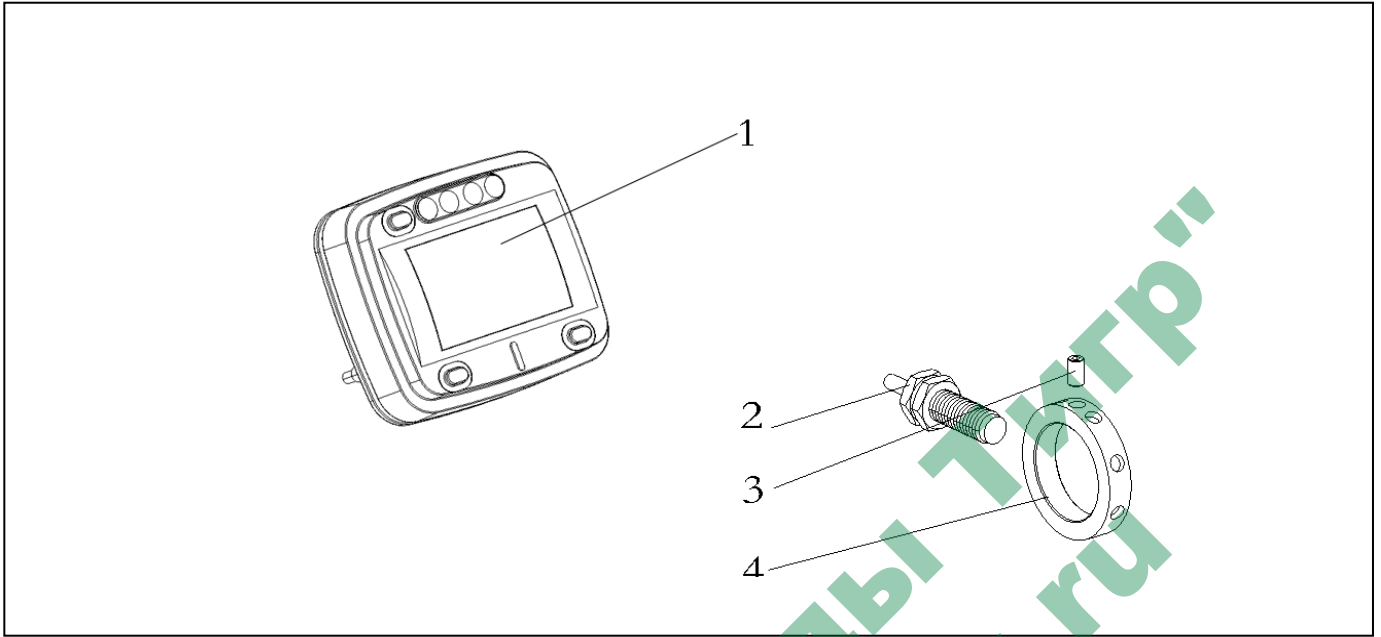

序号 NO.	零件号 Part Number.	零件名称 Description	台量 Qty.
1	3820010-401	组合仪表 Combination Meter	1
2	3813012-001	车速传感器 Vehicle Speed Sensor	1
3	Q2840610	内六角平端紧定螺钉 Hexagon Socket Set Screws with Flat Point	1
4	3813013-201	磁缸套 Magnetic Cylinder Sleeve	1



15 电线束 Wiring Harness

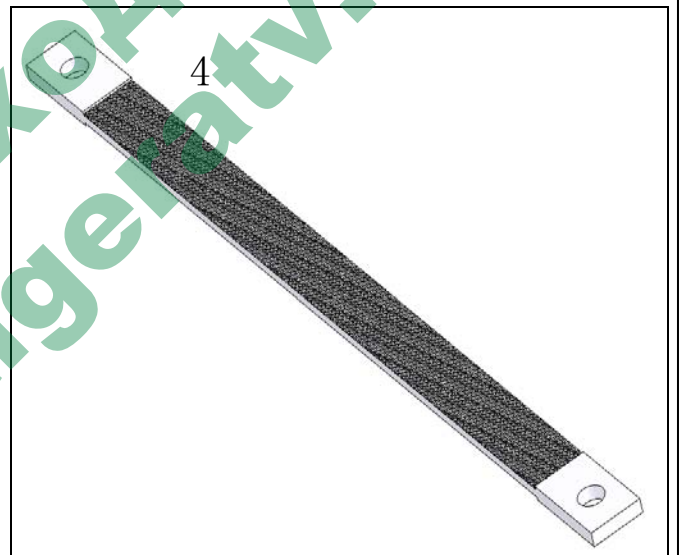
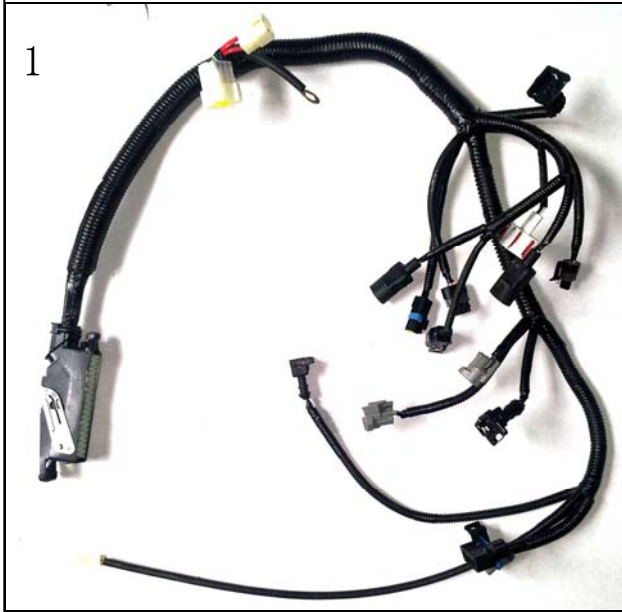

序号 NO.	零件号 Part Number.	零件名称 Description	台量 Qty.
1	4001011-401	发动机线束 Engine Wiring Harness	1
2	4002011-401	车身线束 Body Wiring Harness	1
3	4010011-201-01	电瓶搭铁线 Storage Battery Bond Strap	1
4	4001016-201	发动机铜编织带 Engine Cuprum Mesh Lead	1



16 汽车灯具 Lamps

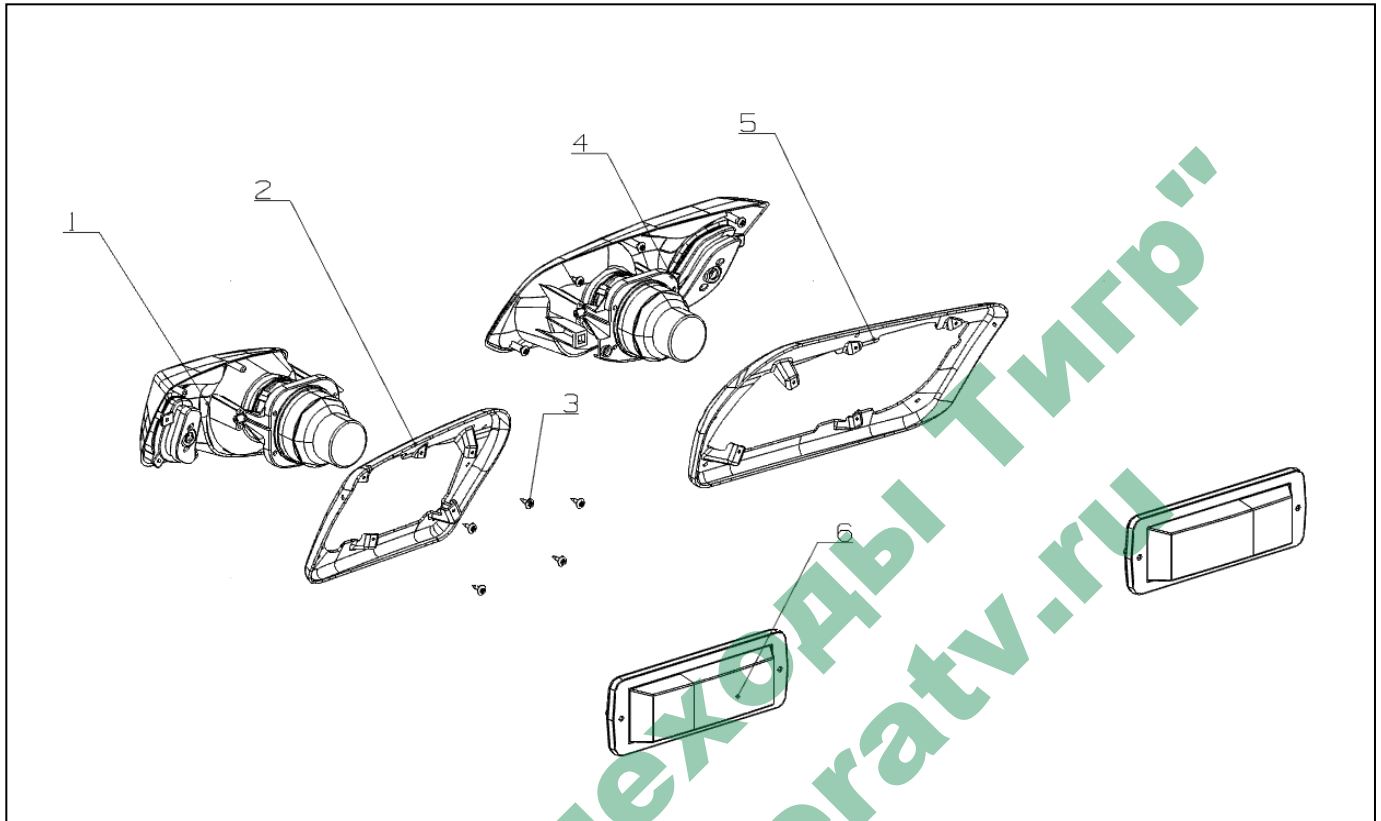

序号 NO.	零件号 Part Number.	零件名称 Description	台量 Qty.
1	4101011-401	左前大灯 Left Headlamps	1
2	4101021-401	左大灯固定支架 Left Headlamps Bracket	1
3	Q2714216	十字槽盘头自攻螺钉 Cross Recessed Pan Head Tapping Screws	10
4	4101012-401	右前大灯 Left Headlamps	1
5	4101022-401	右大灯固定支架 Right Headlamps Bracket	1
6	4133011-401	组合后灯 Combination Tail Lamp	2



17 特种设备 Special Equipment

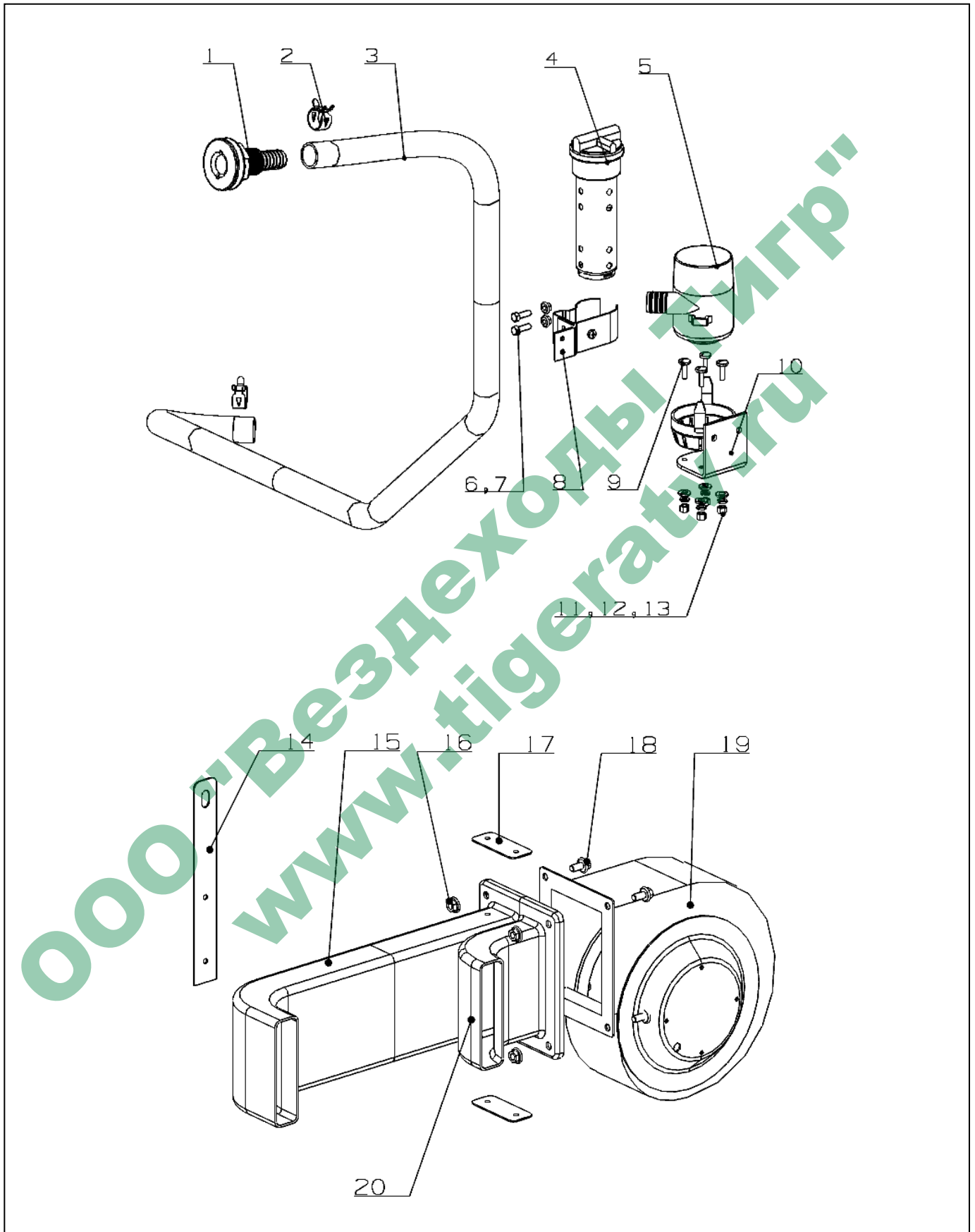



序号 NO.	零件号 Part Number.	零件名称 Description	台量 Qty.
1	4203015-001	水喉 Water Throat	1
2	Q673B21	钢带型弹性环箍 Elastic Steel Hoop	2
3	4203016-401	排水钢丝管 Drainage Pipe Steel Wire	1
4	4203013-001	液位开关 Liquid Level Switch	1
5	4203011-001	潜水泵 Submersible Pump	1
6	Q150B0516	六角头螺栓 Hexagon-headed Bolt	2
7	Q32005	六角法兰面螺母 Hexagon Nut with Flange	2
8	4203014-201	液位开关支架 Liquid Level Switch Stents	1
9	Q2140416	十字槽盘头螺钉 Cross Recessed Pan Head Screw	4
10	4203012-201	潜水泵支架 Submersible Pump Bracket	1
11	Q340B04	1型六角螺母 1Type Hexnut	4
12	Q40104	平垫圈 Flat Washer	4
13	Q40304	弹簧垫圈 Spring Washer	4
14	4202031-401	吹风口支架 Air Hole Holder	1
15	4202021-401	左吹风口 Left Air Hole	1
16	Q32006	六角法兰面螺母 Hexagon Nut with Flange	4
17	4202026-401	吹风口连接件 Air Hole Link	2
18	Q1840612	六角法兰面螺栓 Hexagon Bolt with Flange	4
19	4202010-201	蜗壳无刷风机 Volute Brushless Draught Fan	1
20	4202022-401	右吹风口 Right Air Hole	1



18 牵引骨架 Draw Frame

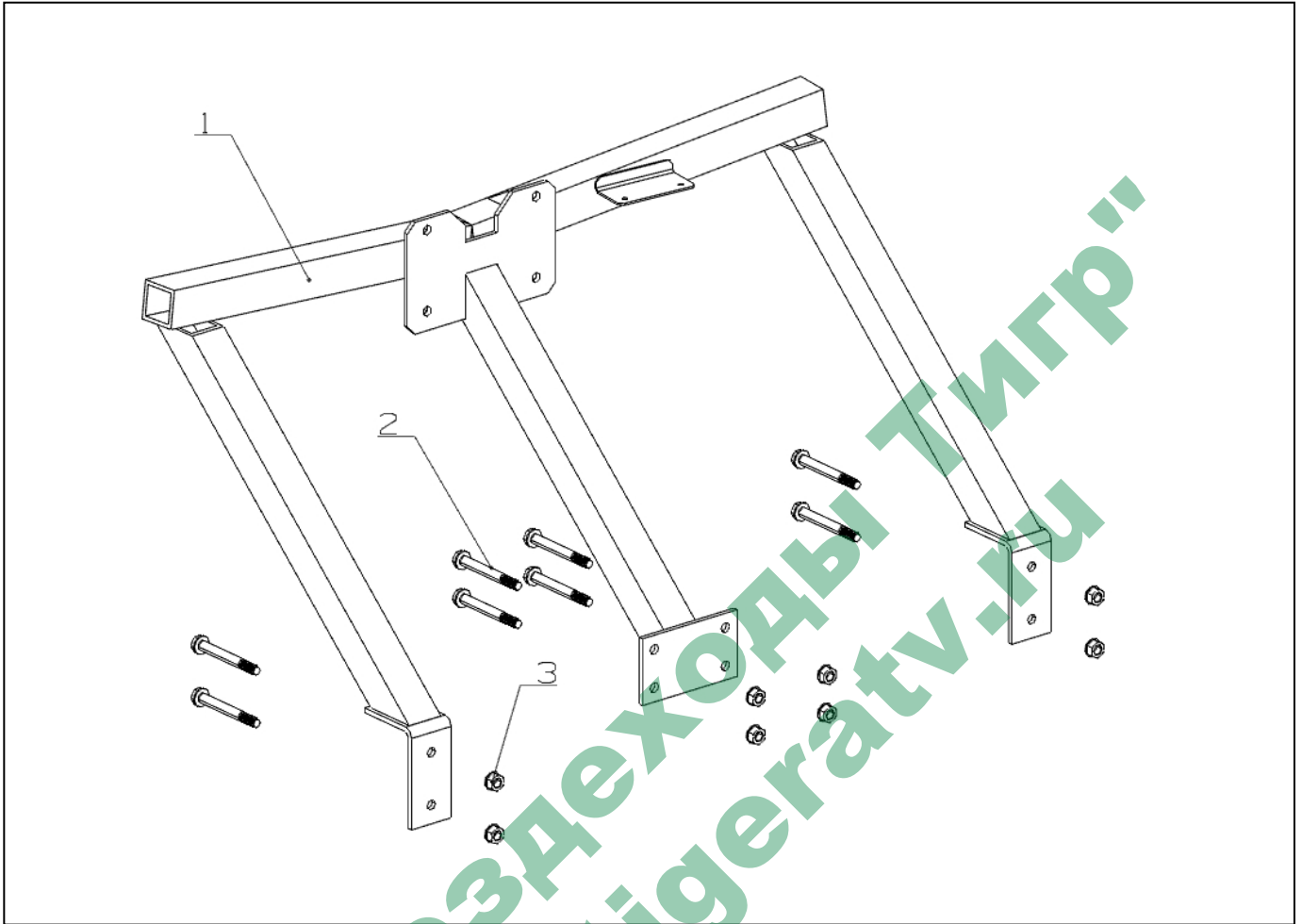

序号 NO.	零件号 Part Number.	零件名称 Description	台量 Qty.
1	4507030-401	绞盘支撑架总成 Winch Bracket Assembly	1
2	Q1841080	六角法兰面螺栓 Hexagon Bolt with Flange	8
3	Q32010	六角法兰面螺母 Hexagon Nut with Flange	8



19 车身 Vehicle Body

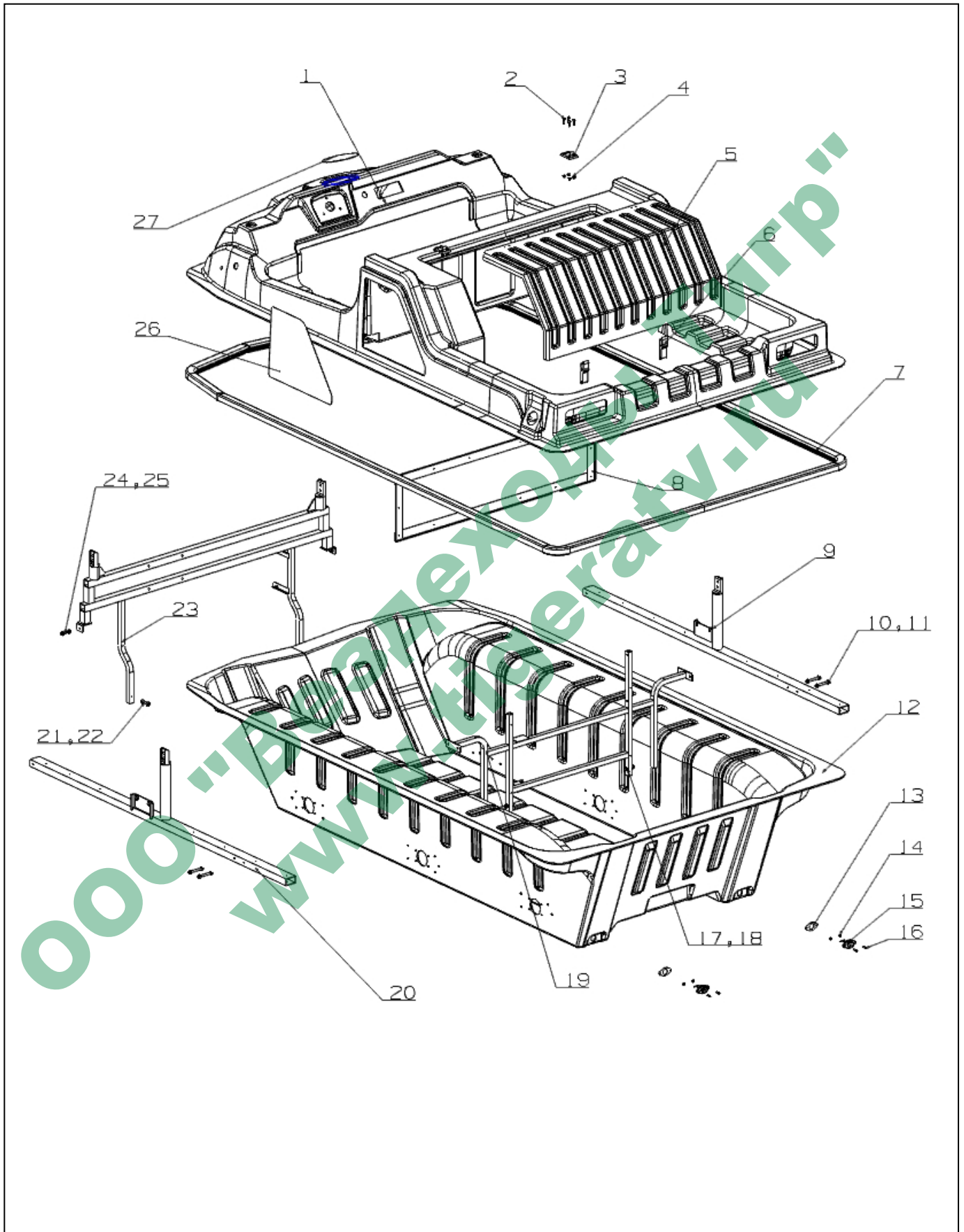



序号 NO.	零件号 Part Number.	零件名称 Description	台量 Qty.
1	5020011-401	上车体 Body, Upper	1
2	QX9700620	内六角平圆头螺钉 M8x30 Hexagon Socket Button Head Screws M8x30	8
3	5020015-401	铰链总成 Hinge	2
4	Q32005	六角法兰面螺母 Hexagon Nut with Flange	8
5	5020013-401	引擎盖 Engine Hood	1
6	5020023-401	引擎盖扣 Engine Hood Hinge	2
7	5020019-401	防水胶套 Airproof Rubber Cover	1
8	5020020-401	机舱加强骨架总成 Engine room Enhance Framework	1
9	5010050-401	下车体右纵向骨架总成 Body Lower Right Portrait Framework	1
10	Q1840865	六角法兰面螺栓 Hexagon Bolt with Flange	2
11	Q32008	六角法兰面螺母 Hexagon Nut with Flange	2
12	5020012-401	下车体 Body, Lower	1
13	5020025-001	放水孔纸垫 Plug-hole, Paper Pad	2
14	Q32005	六角法兰面螺母 Hexagon Nut with Flange	4
15	5020022-001	放水孔 Plug-hole	2
16	Q2560520	十字槽半沉头螺钉 Countersunk Raised Head Screws with Cross Recess	4
17	Q1840840	六角法兰面螺栓 Hexagon Bolt with Flange	2
18	Q32008	六角法兰面螺母 Hexagon Nut with Flange	2
19	5020110-401	机舱骨架总成 Engine room Framework	1
20	5010040-401	下车体左纵向骨架总成 Body Lower Left Portrait Framework	1
21	Q1840840	六角法兰面螺栓 Hexagon Bolt with Flange	2
22	Q32008	六角法兰面螺母 Hexagon Nut with Flange	2
23	5010020-401	下车体横向骨架总成 Body Lower Landscape Orientation Framework	1
24	Q1841016	六角法兰面螺栓 Hexagon Bolt with Flange	2
25	Q32010	六角法兰面螺母 Hexagon Nut with Flange	2
26	5020019-401	通风窗 Ventilation window	2
27	3921010-001	标志 Logo	1



20 护板 Fender Apron

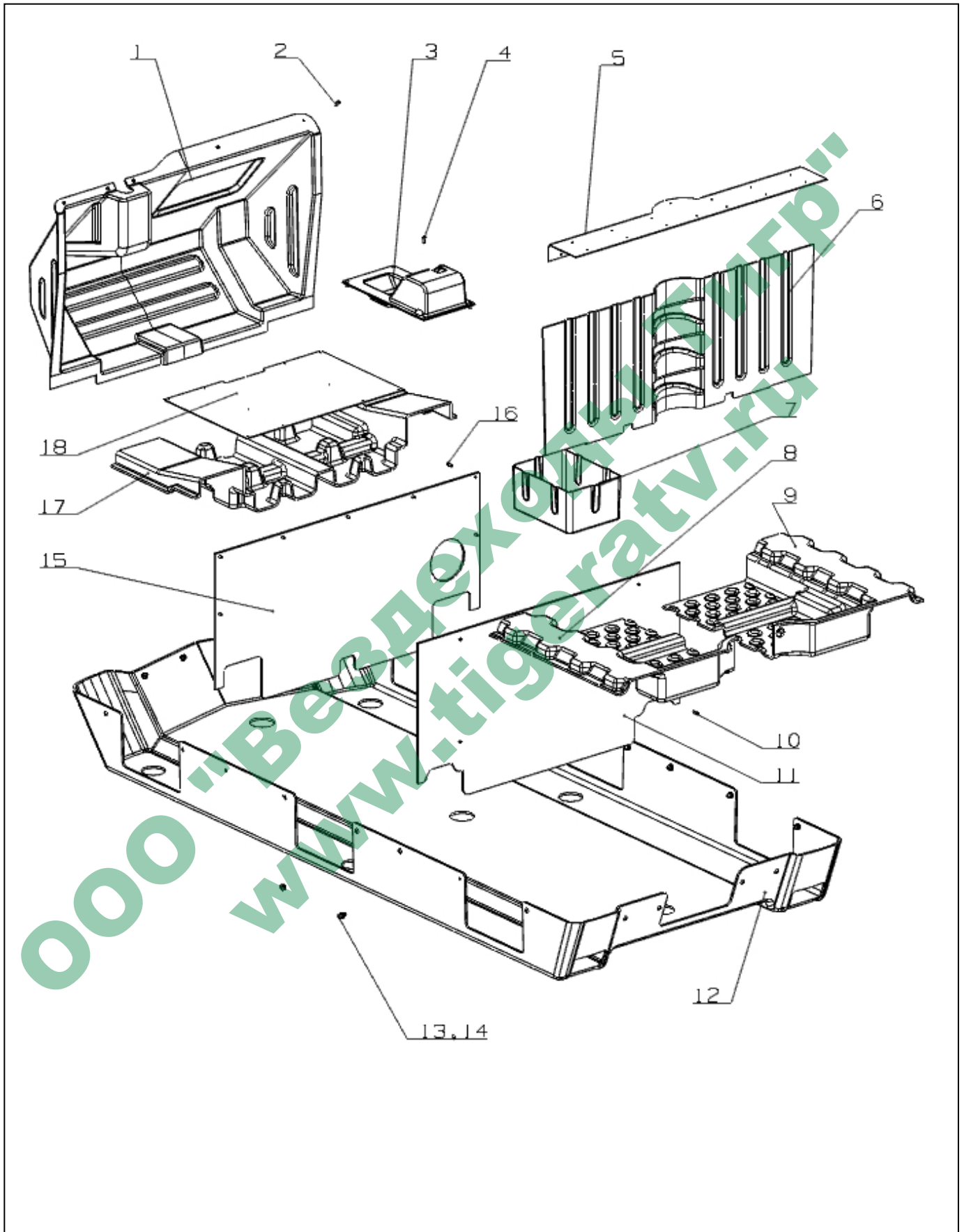



序号 NO.	零件号 Part Number.	零件名称 Description	台量 Qty.
1	5121012-401	前围装饰板 Front Wall Trim	1
2	QX9700620	内六角平圆头螺钉 M6×16 Hexagon Socket Button Head Screws M6×16	5
3	5121101-401	换挡机构装饰罩 Shifting Trim	1
4	QX9700616	内六角平圆头螺钉 M6×16 Hexagon Socket Button Head Screws M6×16	4
5	5121091-401	上车体后护板 Body Upper-Fender Apron, Rear	1
6	5121061-401	油箱护板 Fender Apron, Fuel Tank	1
7	5121071-201	蓄电池漏液接盘 Storage Battery Weeping Acceptance	1
8	5121051-401	后左踏板 Rear Left Floor	1
9	5121051-401	后右踏板 Rear Right Floor	1
10	QX9700616	内六角平圆头螺钉 M6×16 Hexagon Socket Button Head Screws M6×16	4
11	5121031-401	动力舱后挡板 Engine Room Clapboard	1
12	5121017-401	下车体护套 Body Lower-Protecting Bush	1
13	QX97000820	内六角平圆头螺钉 M6×16 Hexagon Socket Button Head Screws M6×16	24
14	Q32008	六角法兰面螺母 Hexagon Nut with Flange	24
15	5121016-401	驾驶员座前挡板 Driver Seat Head Board	1
16	QX97000820	内六角平圆头螺钉 M6×16 Hexagon Socket Button Head Screws M6×16	7
17	5121011-401	驾驶室踏板 Cab Floor	1
18	5121071-401	驾驶室脚踏铝板 Cab Aluminium Floor	1



21 车篷及侧围 Roof Head Lining and Side Wall

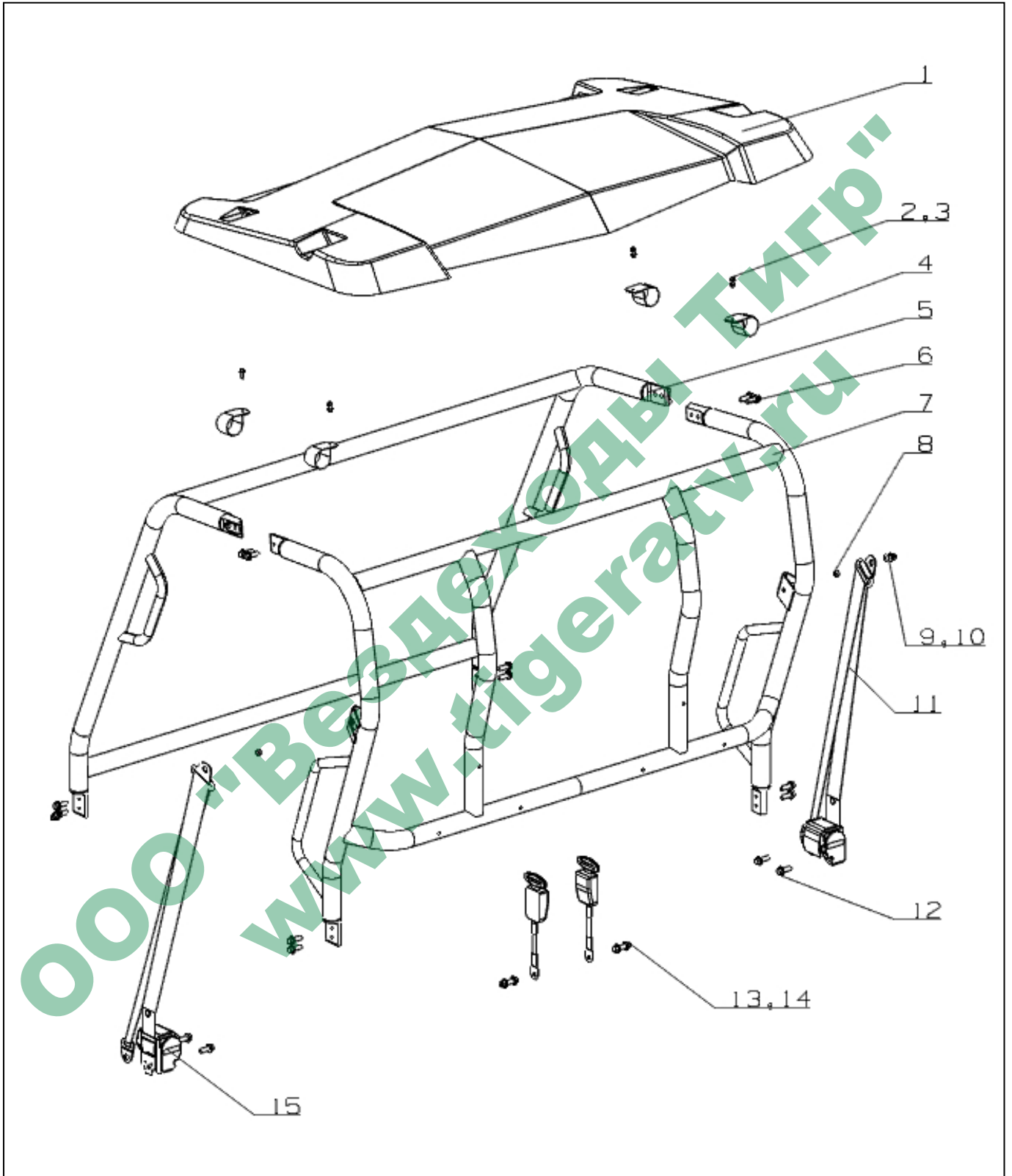



序号 NO.	零件号 Part Number.	零件名称 Description	台量 Qty.
1	6004050-401	顶棚 Roof	1
2	Q1840616	六角法兰面螺栓 Hexagon Bolt with Flange	4
3	Q32006	六角法兰面螺母 Hexagon Nut with Flange	4
4	5200012-401	挡风玻璃固定件 Windshield Bracket	4
5	6004020-401	前支撑管总成 Front Roll Frame	1
6	Q1841025	六角法兰面螺栓 Hexagon Bolt with Flange	12
7	6004020-401	前支撑管总成 Rear Roll Frame	1
8	5810026-401	安全带垫块 Safety Belt Block	2
9	QX9701020	内六角平圆头螺钉 M10x20 Hexagon Socket Button Head Screws 10x20	2
10	Q32010	六角法兰面螺母 Hexagon Nut with Flange	2
11	5810022-401	副驾驶员安全带 Right Safety Belt	1
12	Q1841020	六角法兰面螺栓 Hexagon Bolt with Flange	4
13	Q1841040	六角法兰面螺栓 Hexagon Bolt with Flange	2
14	Q32010	六角法兰面螺母 Hexagon Nut with Flange	2
15	5810021-401	驾驶员安全带 Left Safety Belt	1



22 驾驶员座 Driver Seat

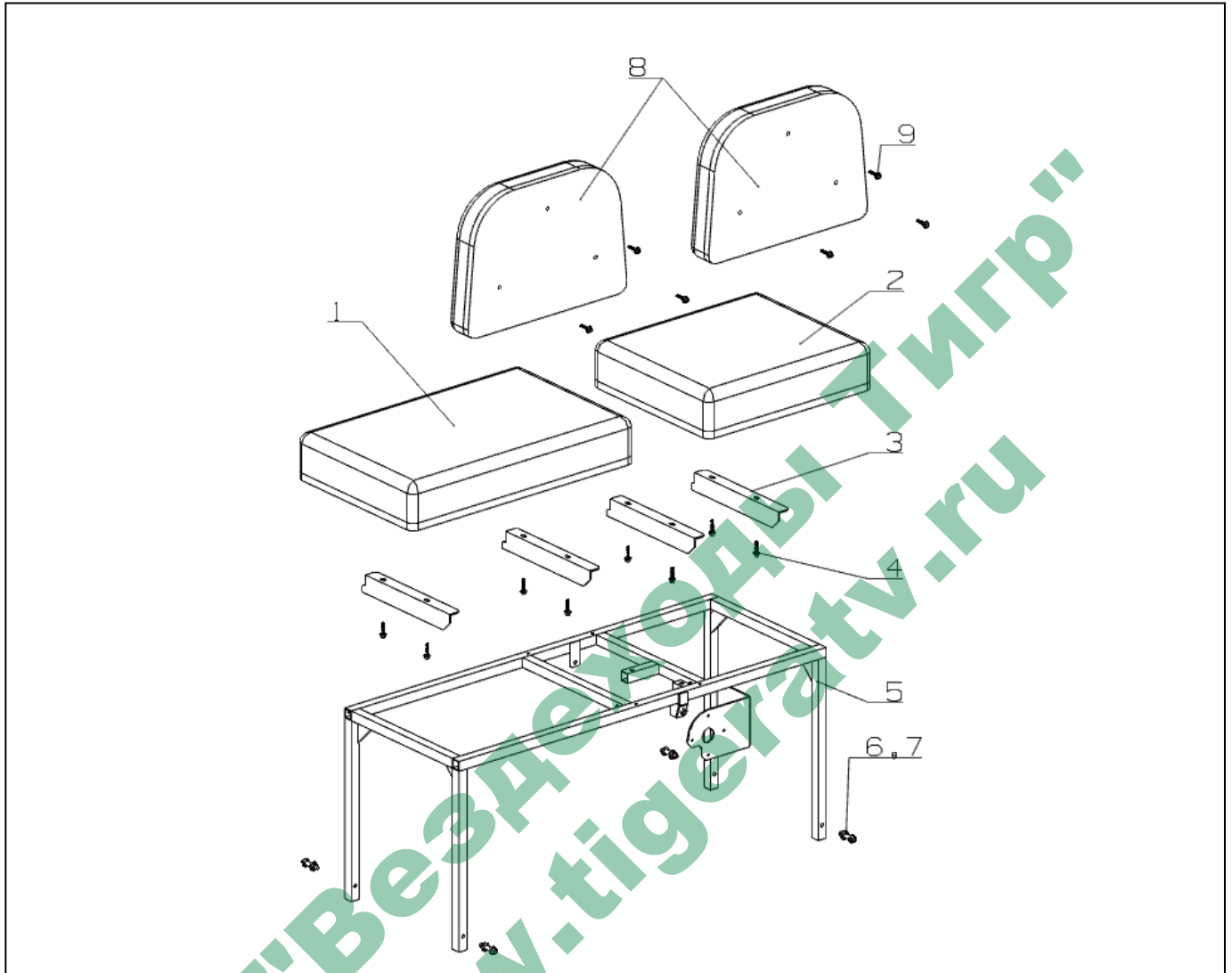

序号 NO.	零件号 Part Number.	零件名称 Description	台量 Qty.
1	6803020-401	驾驶员座垫 Cushion Driver	1
2	6803030-401	副驾驶室座垫 Cushion, Front Passenger	1
3	6803021-201-01	座垫左固定件 Toggle, Left Cushion	4
4	Q1840625	六角法兰面螺栓 Hexagon Bolt with Flange	8
5	6801010-401	驾驶员座骨架总成 Driver Seat-Framework	1
6	Q1840835	六角法兰面螺栓 Hexagon Bolt with Flange	4
7	Q32008	六角法兰面螺母 Hexagon Nut with Flange	4
8	6805030-401	驾驶室靠背垫 Driver Backrest Cushion	2
9	QX9700660	内六角平圆头螺钉 M8x50 Hexagon Socket Button Head Screws M8x50	6



23 后座 Rear Passenger Seat

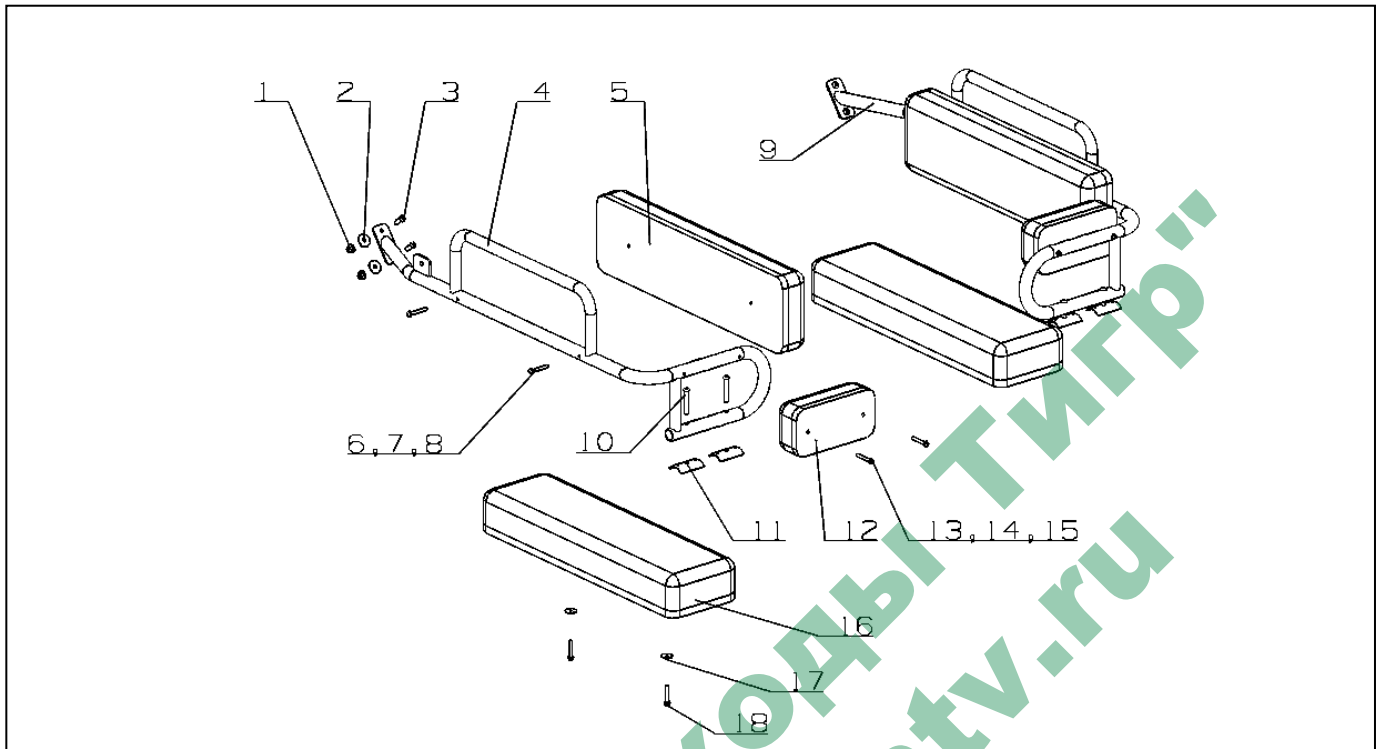

序号 NO.	零件号 Part Number.	零件名称 Description	台量 Qty.
1	Q32008	六角法兰面螺母 Hexagon Nut with Flange	4
2	Q40208	大垫圈 Big Washer	4
3	QX9700825	内六角平圆头螺钉 M8x25	4
4	7006115-401	左高护栏骨架总成 Left High Fence Frame	1
5	7003020-401	后靠背垫 Back Cushion	2
6	QX9700645	内六角平圆头螺钉 M6x45 Hexagon Socket Button Head Screws M6x45	4
7	Q40306	弹簧垫圈 Spring Washer	4
8	Q40106	平垫圈 Flat Washer	4
9	7006120-401	右高护栏骨架总成 Right High Fence Frame	1
10	QX9700850	内六角平圆头螺钉 M8x50 Hexagon Socket Button Head Screws M8x50	4
11	7002020-001	扶手托板 Armrest Fence Fixture	4
12	7005040-201	后乘客保护垫 Right Passenger Neonychium	2
13	QX9700645	内六角平圆头螺钉 M6x45 Hexagon Socket Button Head Screws M6x45	4
14	Q40306	弹簧垫圈 Spring Washer	4
15	Q40106	平垫圈 Flat Washer	4
16	7003010-401	后座垫 Cushion, Rear	2
17	Q40206	大垫圈 Big Washer	4
18	Q1840635	六角法兰面螺栓 Hexagon Bolt with Flange	4



24 钣金件 Sheet-Metal Parts

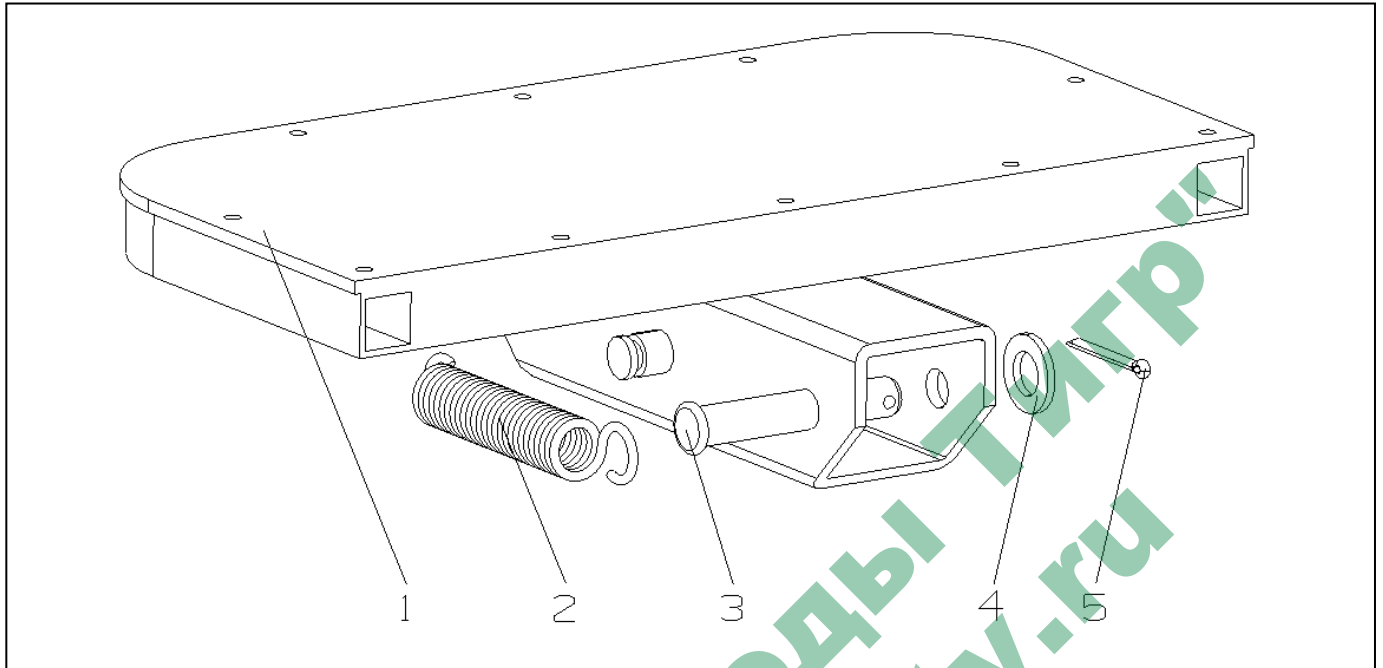

序号 NO.	零件号 Part Number.	零件名称 Description	台量 Qty.
1	8405010-001	后脚踏板 Foot Treadle, Rear	1
2	8405019-001	后脚踏板拉簧 Foot Treadle, Rear-Tension Spring	1
3	Q5101270	销轴 Clevis Pin with Head	1
4	Q40112	平垫圈 Flat Washer	1
5	Q5003236	开口销 Split Pin	1



25 电气原理图 Electric Circuit Diagram

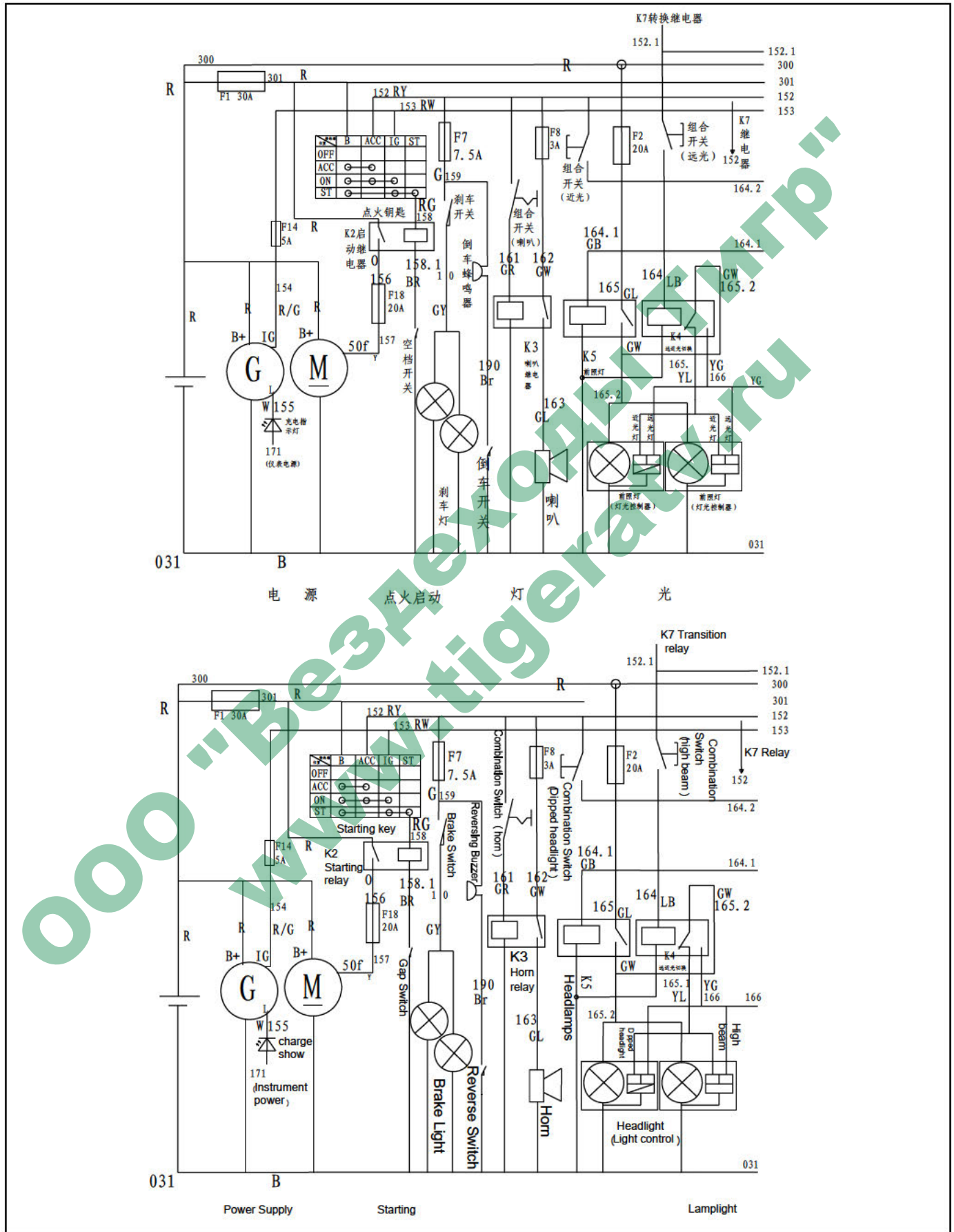

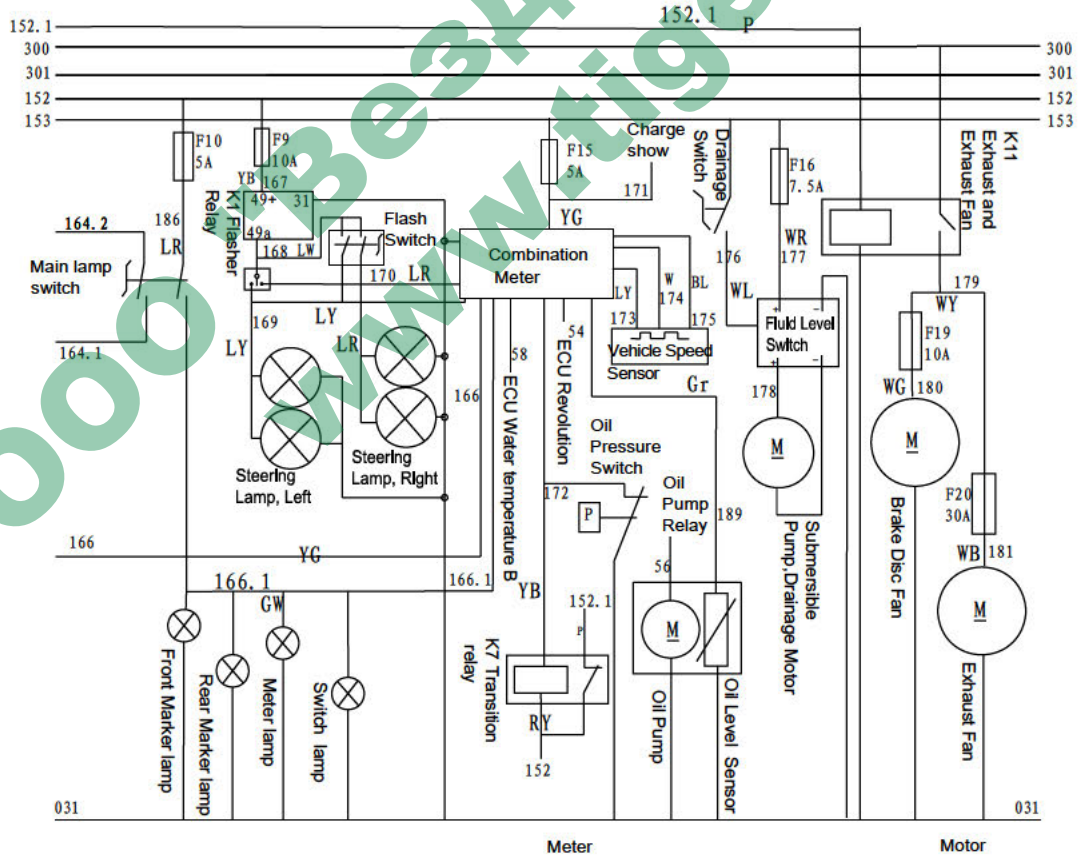
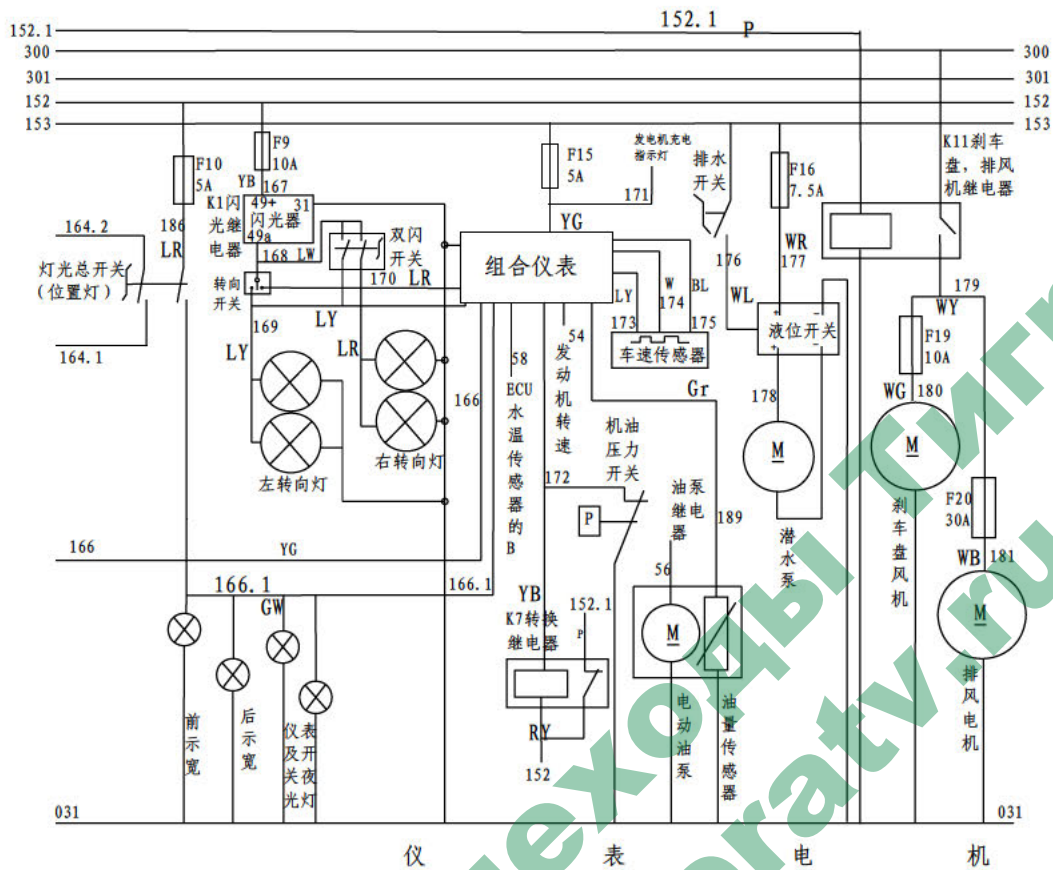

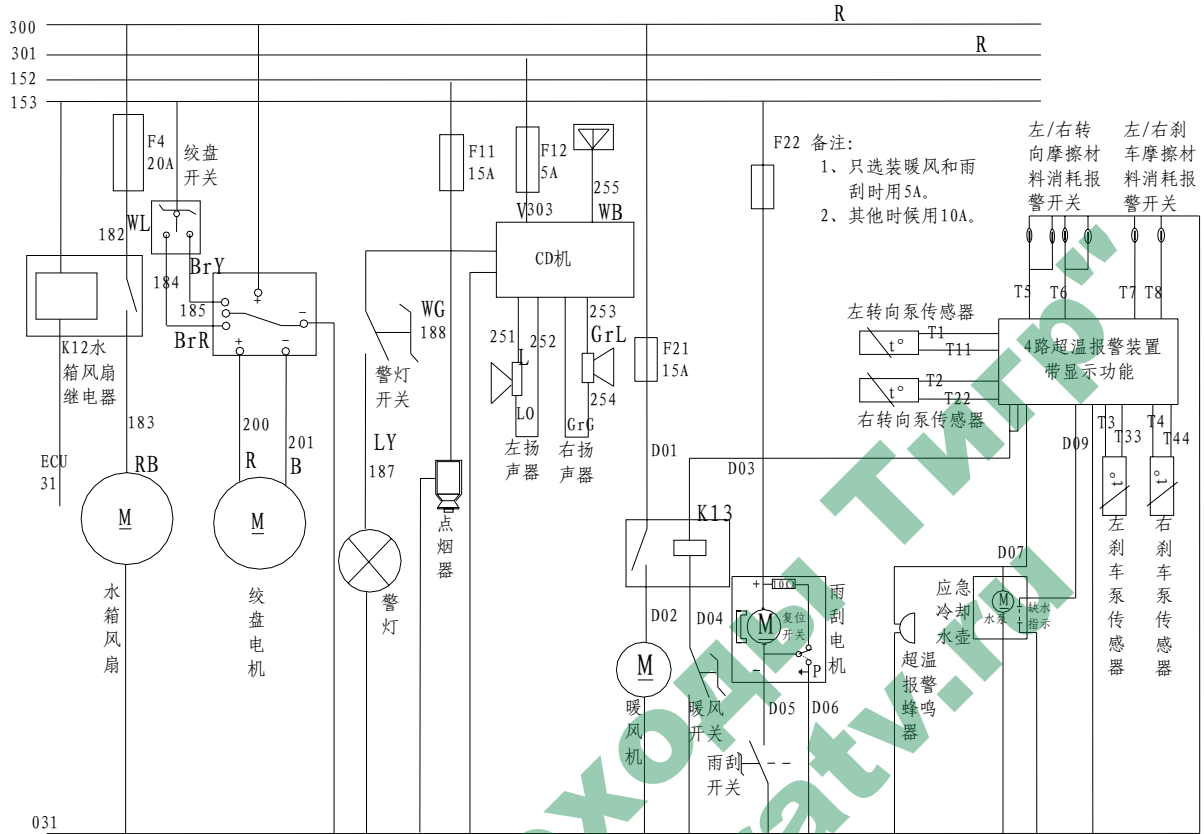

选 装 件

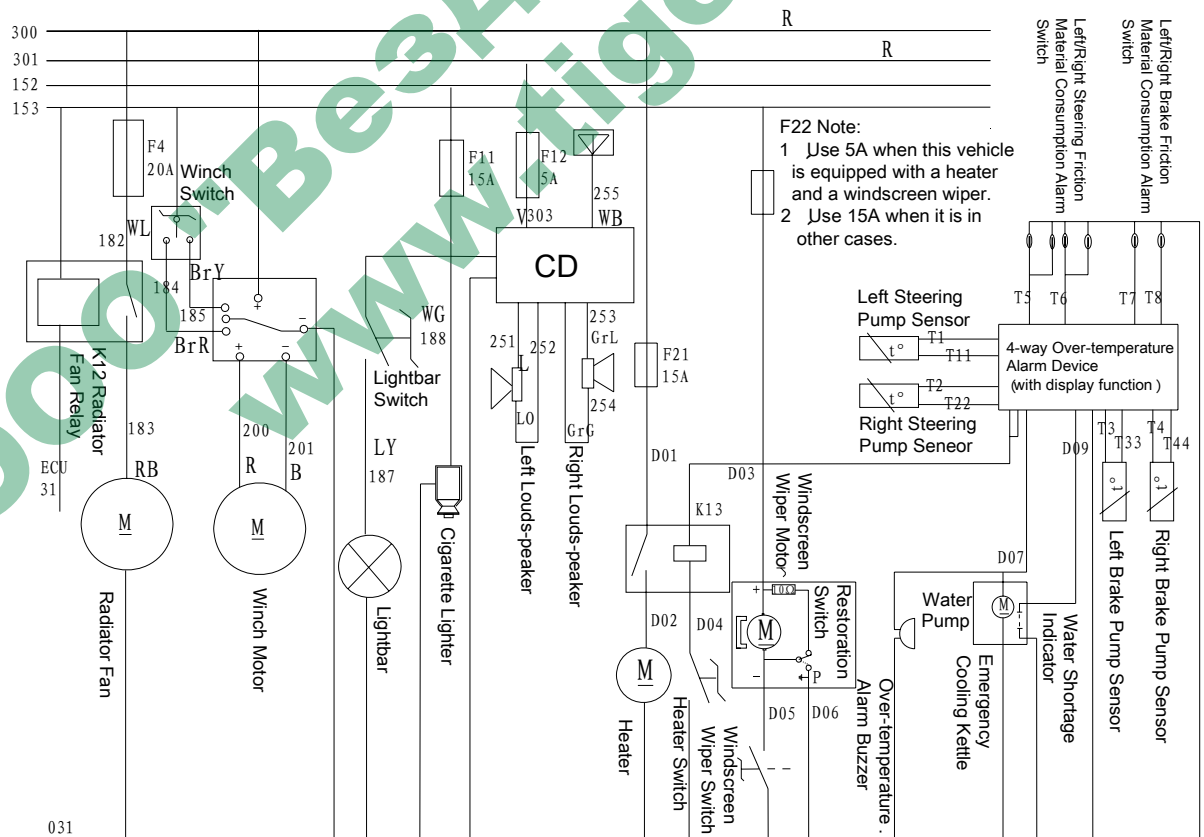

Option



26 EFR 原理图 EFR Circuit Diagram

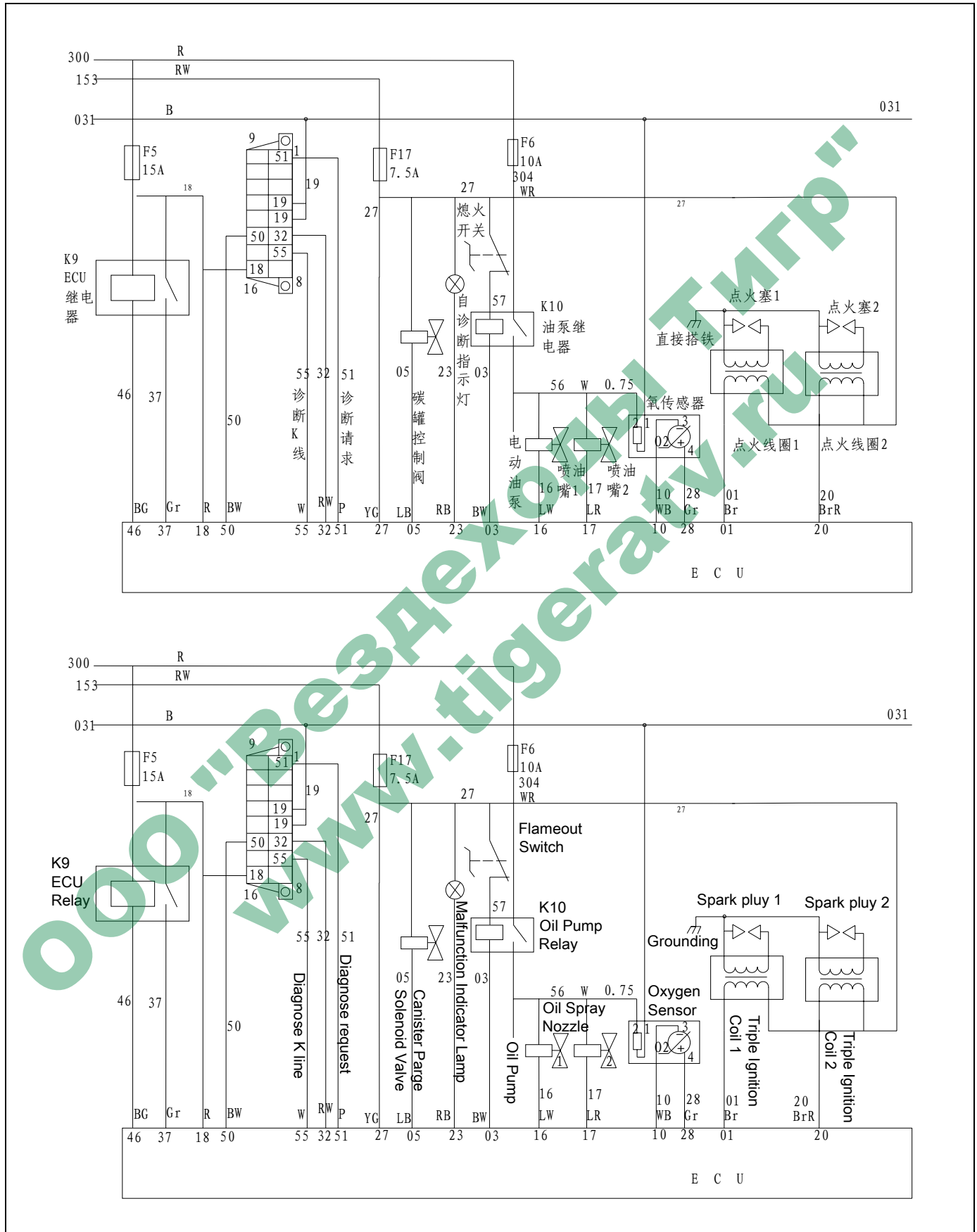



031

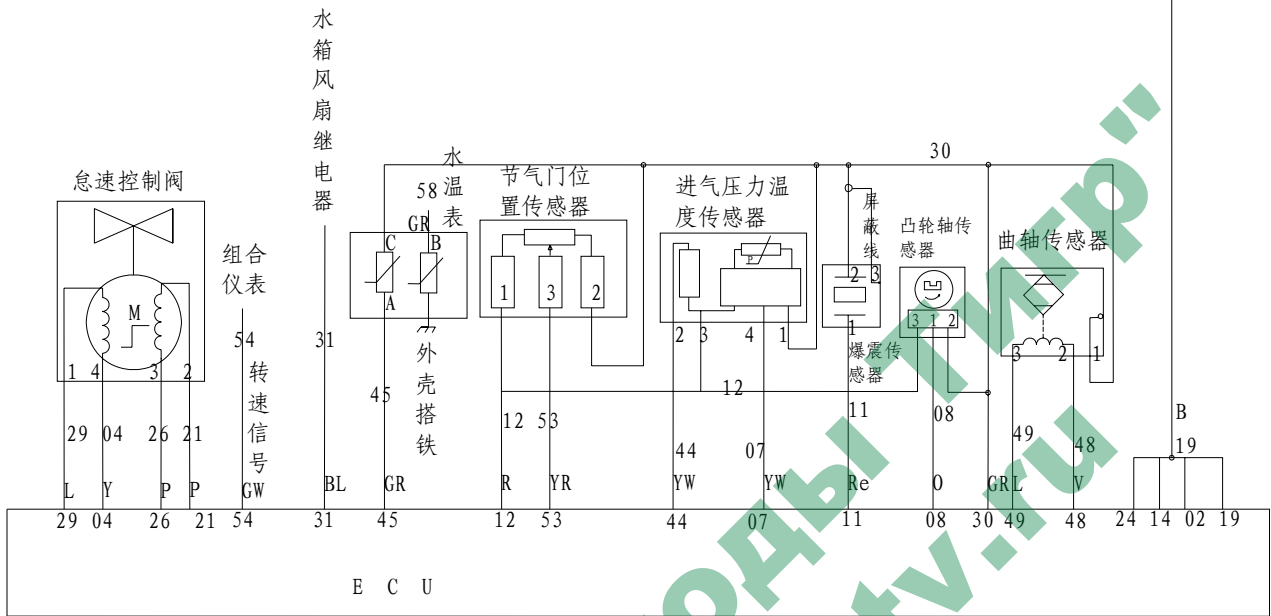

031

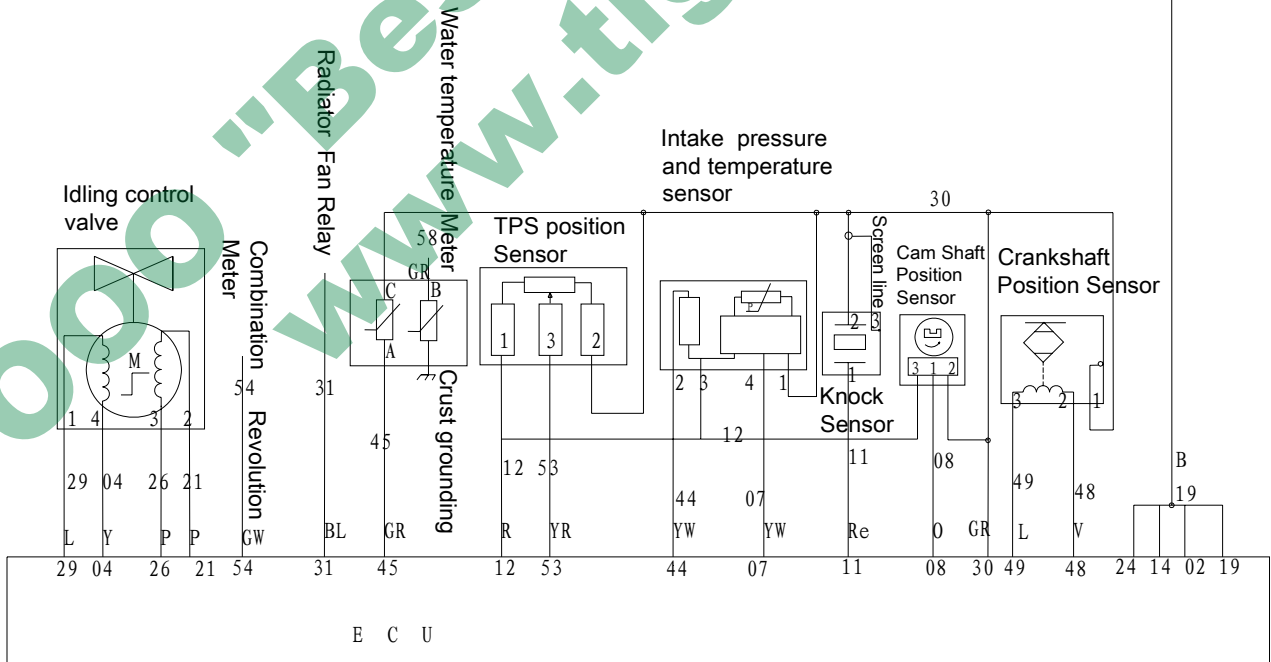



WWW.CHINAXBH.COM

中国义乌西贝虎特种车辆有限公司

Xibei Hu Special Vehicle Co., Ltd. Yiwu China

电话 Tel: 0086-579-85421888

传真 Fax: 0086-579-85421777

Email: export@chinaxbh.com

jwL62@chinaxbh.com

地址: 浙江省义乌市机场路 629 号 (北苑工业区)

Add: No.629 Airport Road Yiwu Zhejiang Province, China.

第一版: 2013-06 First edition: 06-2013

中国印制 2013-06-14

Printed in China 2013-06-14